

www.snowman.cn/en

Version Number: C-RC02-EN-V2.0

雪人集团
SNOWMAN GROUP



Official LinkedIn



Sales Network

FUJIAN SNOWMAN GROUP CO., LTD.

Address: No. 8 Dongjiang West Road, Changle District, Fuzhou, Fujian, China.

Tel: +86 (591) 2870 1111

Fax: +86 (591) 2870 9222

E-mail: info@snowkey.com

www.snowman.cn/en

Snowman Group reserves the right to change its products without notice in advance.
The technical parameters shall be subject to order contract or technical appendix of the contract.

RefComp

Reciprocating Compressor

SP Series Semi-hermetic Reciprocating Compressor



Commercial
Reciprocating
Advanced
Technology

Originated from Italy,
advanced screw &
reciprocating compressor
technologies.

Global Service Hotline
400-109-6660



CONTENT

Description	Page
Structural Diagram	01
Model Description	03
Technical Parameters	04
Product Features	05
Application Range	05
Performance Parameters	06
Product Supply	14
Dimension Diagram	15

Structural Diagram of RefComp SP Series Semi-hermetic Reciprocating Compressor

The SP series reciprocating compressors are widely used series compressors, available in 2/4/6/8 cylinder models with a power range of 3~70HP. They are extensively applied in various commercial and industrial refrigeration fields as well as air conditioning fields. With novel concepts and designs, SP series compressors are compatible with green refrigerants such as R290. In both modern construction sector where high efficiency and energy conservation are pursued and other sectors with strict requirement for refrigeration quality, SP series are ultimate choices regarding their.

Safety valve

- The built-in safety valve connects high pressure and low pressure sides, ensuring smooth operation of the compressors;
- The high-specification safety valve is designed with reliable sealing and sensitive operation.



Cooling capacity control

- Control cooling capacity according to the load;
- The refrigeration capacity control range is divided as follows: for the 4-cylinder model, 50% refrigeration capacity; for the 6-cylinder model, 66% to 33% refrigeration capacity; and for the 8-cylinder model, 75% to 50% refrigeration capacity. This design maximizes the ability to meet the system's refrigeration capacity.

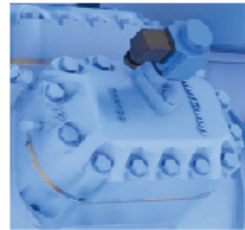

Compressor body

- The designated pressure is as high as 30 bar;
- The design of low pressure drop intake air flow path enables sufficient cooling of motor;
- The direct air flow path in the middle reduces the pressure loss along the way;
- low exhaust loss and low energy consumption;
- The components such as the highly integrated temperature sensor, stop valve, and suction filter are designed in a compact structure, effectively enhancing the reliability of the equipment.

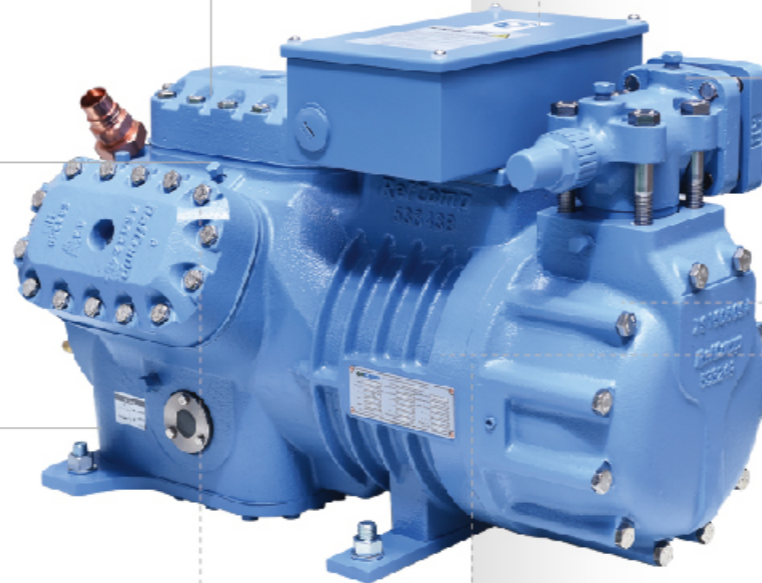

Crankshaft, connecting rods, and piston

- The balanced crankshaft, designed based on rotor dynamics, ensures rigidity while reducing vibration;
- High efficiency, high strength, low air flow pulsation and low noise, the adoption of new technologies has achieved a leading level among similar products;
- Optimized design improves the compress efficiency, widely used in low and medium temperature refrigeration condition;
- The connecting rod and piston are connected through a piston pin. The small end of the connecting rod is equipped with wear-resistant bearing shells, which can extend service life.



Motor protection

- Equipped with INT79B2 motor protection model which enables dynamic monitoring thus guaranteeing the safe operation of the compressor.



Shut-off valve

- The suction/discharge shut-off valve can be rotated, offering simple, compact, and flexible installation.

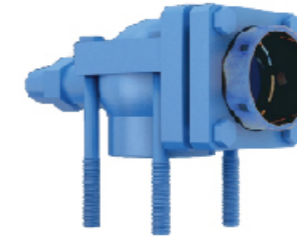

Suction filter

- The integrated delicate suction filter enables filter impurities from refrigeration gases effectively while offering protection;
- Located at the utmost end of the motor with compact structure and easy replacement.

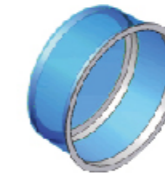

Bearings

- The combination of slide bearings (bearing shells) thrust washers enables high load capacity, high wear resistance, low noise thus extend the service life of the products;
- High wear resistance and appropriate lubrication ensure the service life of 50~80 thousand hours.



Motor

- The high efficiency PW model motor with low starting current resulting in high energy efficiency;
- Designed for various operating voltages and frequencies according to different regional voltage requirements, to meet a wide range of voltage needs;
- Special customized materials enable compatibility with multiple refrigerants, including R22, R407C, R134a, R404A, and R507A;
- A unique structural design and spatial layout utilize the suction refrigerant to effectively cool the dr.

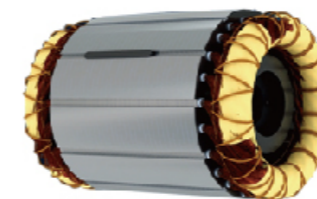

Model Description

Compressor	SP	4	H	N	2000
	SP	4	L	F	080E

Series	
SP	Semi-hermetic reciprocating piston

Cylinder	
SP Series: 2, 4, 6, 8	

Motor type	
H	High temperature compressor motor
L	Cryogenic compressor motor

Lubrication method (for SP series only)	
F	Forced lubrication (with oil pump)
N	Splash lubrication (without oil pump)

Nominal power of the motor HP X 100(2)

(1) For the 4-cylinder models only: 10~20 [HP] high-temperature compressors and 6~12 [HP] low-temperature compressors.

(2) Models with the letter "E" at the end indicate compressors using POE oil.

Technical parameters

Model SP		H (high temperature compressor)																
		SP2H				SP4HF/SP4HN				SP4H				SP6H			SP8H	
		0500	0600	0800	0900	1000	1200	1500	2000	2200	2500	3000	3500	3700	4000	5000	6000	7000
Rated power	HP/kW	5/3.7	6/4.4	8/5.9	9/6.6	10/7.5	12/8.9	15/11.2	20/14.9	22/16.4	25/18.7	30/22.4	35/26.1	37/27.6	40/29.9	50/37.3	60/45	70/52
Displacement	m ³ /hr	17.5/21	21/25.2	24.5/29.4	28/33.6	35/42	42/50.4	49/58.8	56/67.2	64.7/77.6	75/90	86.1/103.3	102.9/123.5	112.5/135	129.1/154.9	154.4/185.3	186/224	222/268
Cylinder number		2				4				6			8					
Weight	kg	86	87	87	91	143	146	152	155	193	206	209	238	241	246	250	345	350
Oil charge	dm ³	1.8	1.8	1.8	1.8	2.6	2.6	2.6	2.6	3.7	3.7	3.7	3.7	4.2	4.2	4.2	5	5
Crankcase heater electrical parameters		230V-120W-50/60Hz -PTC				230V-200W-50/60Hz -PTC				230V-150W-50/60Hz						230V-200W-50/60Hz		
Discharge pipe inner diameterΦ	mm/inch	16/5/8"	16/5/8"	22/7/8"	22/7/8"	22/7/8"	28/1 1/8"	28/1 1/8"	28/1 1/8"	28/1 1/8"	28/1 1/8"	28/1 1/8"	35/1 3/8"	35/1 3/8"	35/1 3/8"	42/1 5/8"	54/2 1/8"	54/2 1/8"
Suction pipe inner diameterΦ	mm/inch	28/1 1/8"	28/1 1/8"	28/1 1/8"	28/1 1/8"	28/1 1/8"	35/1 3/8"	42/1 5/8"	42/1 5/8"	42/1 5/8"	54/2 1/8"	54/2 1/8"	54/2 1/8"	54/2 1/8"	54/2 1/8"	54/2 1/8"	67/2 5/8"	67/2 5/8"
Capacity regulation		-	-	-	-	100%,50%				100%,50%			100%,66%,33%			100%,75%,50%		
Standard motor		230V/3/50Hz Y/D (230V-D/400V/Y)				400V/3/50Hz - 460V/3/60Hz ⁽¹⁾ PW												
Starting current PW/DOL	A	54/94	60/104	85/148	97/169	71/110	75/125	86/144	106/168	102/170	123/201	150/243	178/290	178/290	201/330	233/394	271/361	329/439
Maximum operating current	A	12/21	14/24	16/28	20/35	24	27	33	40	37	43	52	56	60	75	93	115	140

Model SP		L (Low temperature compressor)																
		SP2L				SP4LF/SP4LN				SP4L				SP6L			SP8L	
		0300	0400	0500	0600	0600	0800	1000	1200	1500	1800	2200	2500	2700	3000	4000	5000	6000
Rated power	HP/kW	3/2	4/3	5/3.7	6/4.4	6/4.5	8/5.9	10/7.5	12/8.9	15/11.2	18/13.3	22/16.4	25/18.7	27/20.2	30/22.4	40/29.9	50/37	60/45
Displacement	m ³ /hr	17.5/21	21/25.2	24.5/29.4	28/33.6	35/42	42/50.4	49/58.8	56/67.2	64.7/77.6	75/90	86.1/103.3	102.9/123.5	112.5/135	129.1/154.9	154.4/185.3	186/224	222/268
Cylinder number		2				4				6			8					
Weight	kg	84	85	85	86	134	139	144	146	182	186	195	220	230	236	247	340	345
Oil charge	dm ³	1.8	1.8	1.8	1.8	2.6	2.6	2.6	2.6	3.7	3.7	3.7	3.7	4.2	4.2	4.2	5	5
Crankcase heater electrical parameters		230V-120W-50/60Hz -PTC				230V-200W-50/60Hz -PTC				230V-200W-50/60Hz						230V-200W-50/60Hz		
Discharge pipe inner diameterΦ	mm/inch	16/5/8"	16/5/8"	22/7/8"	22/7/8"	22/7/8"	28/1 1/8"	28/1 1/8"	28/1 1/8"	28/1 1/8"	28/1 1/8"	28/1 1/8"	35/1 3/8"	35/1 3/8"	35/1 3/8"	42/1 5/8"	54/2 1/8"	54/2 1/8"
Suction pipe inner diameterΦ	mm/inch	28/1 1/8"	28/1 1/8"	28/1 1/8"	28/1 1/8"	28/1 1/8"	35/1 3/8"	35/1 3/8"	35/1 3/8"	42/1 5/8"	42/1 5/8"	54/2 1/8"	54/2 1/8"	54/2 1/8"	54/2 1/8"	54/2 1/8"	67/2 5/8"	67/2 5/8"
Capacity regulation		-	-	-	-	100%, 50%				100%, 50%			100%, 66%, 33%			100%,75%,50%		
Standard motor		230V/3/50Hz Y400V/3/50Hz				400V/3/50Hz - 460V/3/60Hz ⁽¹⁾ PW												
Starting current PW/DOL	A	35/61	49/85	54/94	60/104	43/70	54/88	71/110	75/125	88/146	102/170	102/170	123/201	123/201	150/243	201/330	237/316	271/361
Maximum operating current	A	9/16	10/17	12/21	14/24	16	19	24	27	29	33	39	43	48	54	75	97	115

(1) Voltage variation range: ±10%

Product features

Strong compatibility of the refrigeration

Compatible with R22, R407C, R134a, R404A, and R507A HFC refrigerants.

High energy efficiency

Equipped with a motor protection module for safe operation. Efficient suction cooling of the motor to reduce energy consumption and improve efficiency;

Adjustable refrigeration capacity levels based on load;

Optimized low compression ratio for enhanced energy efficiency.

Optimized lubrication system

Compact structure

Compact design with high-quality casting materials;

The unit features a compact size, integrating a filter, stop valve, and temperature sensor into a single assembly.

Smooth operation and low noise

Equipped with a crankshaft designed by RefComp with counterweight, taking a leading position among similar products.

Easy installation and high maintainability

Meet the demand of various high-efficiency and high-performance water-cooled, air-cooled, and heat pump units.

Application Range

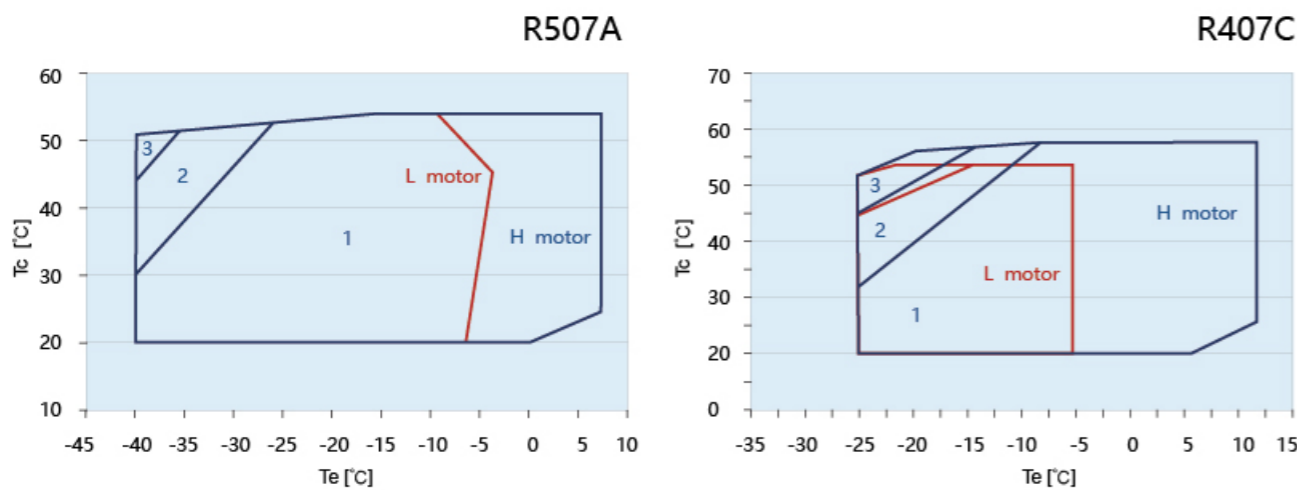

- 1=Standard application range ([25°C] suction temperature)
- 2=Application range with additional cooling
- 3=Application range with additional cooling and maximum 10K suction superheat.
- 4=Application range with additional cooling and liquid injection cooling (LCM) (not applicable for 8-cylinder models SP8H...SP8L)

Performance parameters (SP*H, refrigerant R407C)

SP2H050E								
Tc	30		40		50		58	
Te	Pf	Pa	Pf	Pa	Pf	Pa	Pf	Pa
-25	4.3	1.8	3.4	1.9	2.8	1.9	-	-
-20	5.7	2.2	4.6	2.3	3.7	2.4	-	-
-15	7.5	2.5	6.2	2.7	5.1	2.9	-	-
-10	9.6	2.8	8.2	3.1	6.8	3.3	-	-
-5	12.2	3.0	10.6	3.4	8.9	3.7	7.6	3.9
0	15.3	3.1	13.3	3.6	11.4	4.0	9.8	4.4
5	18.7	3.2	16.5	3.8	14.2	4.4	12.3	4.8
10	22.5	3.3	20.1	4.0	17.5	4.7	15.3	5.1

SP2H060E								
Tc	30		40		50		58	
Te	Pf	Pa	Pf	Pa	Pf	Pa	Pf	Pa
-25	5.2	2.2	4.1	2.3	3.4	2.3	-	-
-20	6.8	2.6	5.5	2.8	4.5	2.9	-	-
-15	6.9	3.0	7.4	3.3	6.4	3.4	-	-
-10	11.6	3.3	9.8	3.7	8.2	3.9	-	-
-5	14.7	3.5	12.7	4.0	10.7	4.4	9.1	4.7
0	18.3	3.7	16.0	4.3	13.7	4.8	11.7	5.2
5	22.4	3.9	19.8	4.6	17.1	5.2	14.8	5.7
10	27.0	3.9	24.1	4.8	21.0	5.5	18.3	6.1

SP2H080E								
Tc	30		40		50		58	
Te	Pf	Pa	Pf	Pa	Pf	Pa	Pf	Pa
-25	6.0	2.5	4.7	2.6	3.9	2.6	-	-
-20	7.9	3.0	6.4	3.2	5.2	3.3	-	-
-15	10.4	3.5	8.6	3.8	7.1	4.0	-	-
-10	13.5	3.8	11.4	4.2	9.5	4.6	-	-
-5	17.1	4.1	14.8	4.7	12.4	5.1	10.6	5.4
0	21.4	4.3	18.7	5.0	15.9	5.6	13.7	6.0
5	26.2	4.5	23.1	5.3	19.9	6.0	17.3	6.6
10	31.5	4.6	28.2	5.6	24.5	6.4	21.4	7.1

SP2H090E								
Tc	30		40		50		58	
Te	Pf	Pa	Pf	Pa	Pf	Pa	Pf	Pa
-25	6.9	2.9	5.4	3.0	4.5	3.0	-	-
-20	9.1	3.5	7.3	3.7	6.0	3.8	-	-
-15	11.9	3.9	9.9	4.3	8.1	4.5	-	-
-10	15.4	4.4	13.1	4.8	10.9	5.2	-	-
-5	19.6	4.7	16.9	5.3	14.2	5.8	12.1	6.2
0	24.4	4.9	21.4	5.7	18.2	6.4	15.6	6.9
5	29.9	5.1	26.5	6.0	22.8	6.9	19.7	7.5
10	36.0	5.2	32.2	6.3	28.0	7.3	24.4	8.1

SP4HF100E/SP4HN100E								
Tc	30		40		50		58	
Te	Pf	Pa	Pf	Pa	Pf	Pa	Pf	Pa
-25	8.6	3.6	6.8	3.7	5.6	3.8	-	-
-20	11.4	4.3	9.2	4.6	7.5	4.8	-	-
-15	14.9	4.9	12.4	5.4	10.2	5.7	-	-
-10	19.3	5.4	16.3	6.0	13.6	6.5	-	-
-5	24.5	5.8	21.1	6.6	17.8	7.3	15.2	7.7
0	30.5	6.2	26.7	7.1	22.8	7.9	19.5	8.6
5	37.4	6.4	33.1	7.5	28.5	8.6	24.7	9.4
10	45.0	6.5	40.2	7.9	35.0	9.2	30.5	10.1

SP4HF120E/SP4HN120E								
Tc	30		40		50		58	
Te	Pf	Pa	Pf	Pa	Pf	Pa	Pf	Pa
-25	10.3	4.3	8.1	4.5	6.7	4.5	-	-
-20	13.6	5.2	11.0	5.5	9.0	5.7	-	-
-15	17.9	5.9	14.8	6.4	12.2	6.8	-	-
-10	23.1	6.5	19.6	7.2	16.3	7.8	-	-
-5	29.4	7.0	25.3	7.9	21.3	8.7	18.2	9.3
0	36.6	7.4	32.0	8.5	27.3	9.5	23.4	10.3
5	44.8	7.6	39.7	9.0	34.2	10.3	29.6	11.2
10	54.1	7.8	48.3	9.5	42.0	11.0	36.7	12.2

SP4HF150E/SP4HN150E								
Tc	30		40		50		58	
Te	Pf	Pa	Pf	Pa	Pf	Pa	Pf	Pa
-25	12.1	5.0	9.5	5.2	7.8	5.3	-	-
-20	15.9	6.0	12.9	6.4	10.5	6.7	-	-
-15	20.9	6.9	17.3	7.5	14.2	7.9	-	-
-10	27.0	7.6	22.9	8.4	19.0	9.1	-	-
-5	34.3	8.2	29.6	9.3	24.9	10.2	21.2	10.8
0	42.7	8.6	37.4	9.9	31.9	11.1	27.3	12.0
5	52.3	8.9	46.3	10.5	39.9	12.0	34.5	13.1
10	63.1	9.1	56.3	11.0	49.0	12.8	42.8	14.2

SP4HF200E/SP4HN200E								
Tc	30		40		50		58	
Te	Pf	Pa	Pf	Pa	Pf	Pa	Pf	Pa
-25	13.8	5.7	10.9	6.0	9.0	6.0	-	-
-20	18.2	6.9	14.7	7.4	12.0	7.6	-	-
-15	23.9	7.9	19.8	8.6	16.3	9.1	-	-
-10	30.9	8.7	26.2	9.6	21.7	10.4	-	-
-5	39.2	9.3	33.8	10.6	28.5	11.6	24.2	12.4
0	48.8	9.8	42.7	11.4	36.4	12.7	31.3	13.7
5	59.8	10.2	52.9	12.0	45.6	13.7	39.5	15.0
10	72.1	10.4	64.4	12.6	56.0	14.7	48.9	16.2

SP4H220E								
Tc	30		40		50		58	
Te	Pf	Pa	Pf	Pa	Pf	Pa	Pf	Pa
-25	15.9	7.2	12.5	8.2	10.3	9.0	-	-
-20	21.0	8.1	17.0	9.4	13.9	10.4	-	-
-15	27.6	9.0	22.9	10.4	18.8	11.8	-	-
-10	35.7	9.7	30.2	11.4	25.1	13.0	-	-
-5	45.3	10.3	39.0	12.2	32.9	14.2	28.0	15.9
0	56.4	10.9	49.3	13.0	42.1	15.3	36.1	17.2
5	69.1	11.3	61.1	13.6	52.7	16.2	45.6	18.5
10	83.3	11.6	74.4	14.1	64.7	17.0	56.5	19.7

SP4H250E								
Tc	30		40		50		58	
Te	Pf	Pa	Pf	Pa	Pf	Pa	Pf	Pa
-25	18.5	8.4	14.6	9.5	12.0	10.4	-	-
-20	24.3	9.4	19.7	10.9	16.1	12.1	-	-
-15	32.0	10.4	26.5	12.1	21.8	13.7	-	-
-10	41.4	11.3	35.0	13.2	29.1	15.1	-	-
-5	52.5	12.0	45.3	14.2	38.1	16.5	32.5	18.4
0	65.4	12.6	57.2	15.0	48.8	17.7	41.9	20.0
5	80.1	13.1	70.9	15.8	61.1	18.8	52.9	21.4
10	96.6	13.5	86.3	16.4	75.1	19.8	65.5	22.8

Performance Parameters (SP*H, Refrigerant R407C)

SP4H300E								
Tc	30			40			58	
Te	Pf	Pa	Pf	Pa	Pf	Pa	Pf	Pa
-25	21.2	9.6	16.7	10.9	13.8	6.5	-	-
-20	27.9	10.8	22.6	12.5	18.4	8.5	-	-
-15	36.7	11.9	30.4	13.9	25.0	10.5	-	-
-10	47.4	12.9	40.2	15.1	33.4	12.5	-	-
-5	60.2	13.8	51.9	16.2	43.7	14.6	37.3	21.1
0	75.0	14.5	65.6	17.2	55.9	16.6	48.0	22.9
5	91.9	15.0	81.3	18.1	70.1	18.6	60.6	24.6
10	110.7	15.4	98.9	18.8	86.1	22.7	75.1	26.1

SP4H350E								
Tc	30			40			58	
Te	Pf	Pa	Pf	Pa	Pf	Pa	Pf	Pa
-25	25.3	11.4	20.0	13.1	16.5	14.3	-	-
-20	33.4	12.9	27.0	14.9	22.0	16.6	-	-
-15	43.8	14.3	36.3	16.6	29.9	18.7	-	-
-10	56.7	15.5	48.0	18.1	39.9	20.7	-	-
-5	72.0	16.5	62.1	19.4	52.3	22.6	44.5	25.2
0	89.7	17.3	78.4	20.6	66.9	24.3	57.4	27.4
5	109.8	17.9	97.2	21.6	83.8	25.8	72.5	29.4
10	132.4	18.4	118.3	22.5	102.9	27.1	89.8	31.3

SP6H370E								
Tc	30			40			58	
Te	Pf	Pa	Pf	Pa	Pf	Pa	Pf	Pa
-25	27.7	12.5	21.8	14.3	18.0	15.6	-	-
-20	36.5	14.2	29.5	16.3	24.1	18.2	-	-
-15	48.0	15.6	39.8	18.1	32.7	20.5	-	-
-10	62.0	16.9	52.6	19.8	43.7	22.7	-	-
-5	78.8	18.0	67.9	21.3	57.2	24.7	48.7	27.6
0	98.1	18.9	85.8	22.5	73.2	26.5	62.8	30.0
5	120.2	19.6	106.3	23.7	91.7	28.2	79.3	32.2
10	144.9	20.2	129.4	24.6	112.6	29.7	98.3	34.2

SP6H400E								
Tc	30			40			58	
Te	Pf	Pa	Pf	Pa	Pf	Pa	Pf	Pa
-25	31.9	14.4	26.1	16.4	20.7	17.9	-	-
-20	42.1	16.3	33.9	18.7	27.7	20.9	-	-
-15	55.1	18.0	45.7	20.8	37.5	23.6	-	-
-10	71.3	19.4	60.4	22.7	50.2	26.1	-	-
-5	90.5	20.7	78.1	24.4	65.8	28.4	56.0	31.7
0	112.8	21.7	98.7	25.9	84.1	30.5	72.2	34.4
5	138.1	22.6	122.2	27.2	105.4	32.4	94.2	37.0
10	166.5	23.2	148.8	28.2	129.4	34.1	112.9	39.3

SP6H500E								
Tc	30			40			58	
Te	Pf	Pa	Pf	Pa	Pf	Pa	Pf	Pa
-25	38.1	17.2	30.0	19.6	24.7	21.4	-	-
-20	50.2	19.5	40.6	22.4	33.1	24.9	-	-
-15	65.9	21.5	54.6	24.9	44.9	28.2	-	-
-10	85.2	23.2	72.2	27.2	60.0	31.2	-	-
-5	108.2	24.7	93.3	29.2	78.6	33.9	67.0	37.9
0	134.8	26.0	117.9	31.0	100.5	36.5	86.3	41.2
5	165.1	27.0	146.1	32.5	125.9	38.7	109.0	44.2
10	199.0	27.7	177.8	33.8	154.7	40.7	135.0	47.0

SP8H600E								
Tc	30			40			58	
Te	Pf	Pa	Pf	Pa	Pf	Pa	Pf	Pa
-25	46.7	20.3	41.5	21.5	33.0	21.8	-	-
-20	62.6	23.4	55.7	25.2	45.9	26.2	-	-
-15	81.1	26.1	72.3	28.6	60.7	30.4	-	-
-10	102.7	28.5	91.6	31.8	77.9	34.4	-	-
-5	127.9	30.6	114.1	34.7	98.2	38.2	85.0	40.6
0	157.1	32.3	140.5	37.3	121.9	41.9	106.8	45.1
5	191.0	33.7	171.2	39.7	149.6	45.4	132.3	49.5
10	230.0	34.7	206.6	41.9	181.8	48.6	162.1	53.8

SP8H700E								
Tc	30			40			58	
Te	Pf	Pa	Pf	Pa	Pf	Pa	Pf	Pa
-25	55.7	24.2	49.5	25.6	39.4	26.0	-	-
-20	74.7	27.9	66.5	30.0	54.7	31.3	-	-
-15	96.8	31.2	86.3	34.1	72.4	36.3	-	-
-10	122.6	34.1	109.3	37.9	93.0	41.1	-	-
-5	152.6	36.5	136.2	41.4	117.2	45.7	101.5	48.5
0	187.5	38.6	167.7	44.6	145.5	50.0	127.5	53.9
5	228.0	40.2	204.3	47.4	178.6	54.1	157.9	59.1
10	274.5	41.4	246.7	50.0	217.0	58.1	193.5	64.2

Key:

Pf = Refrigerant capacity (kW)

Pa = Input power (kW)

Te =Evaporating temperature (°C)

Tc =Condensing temperature(°C)

50Hz = Frequency

Liquid sub cooling 5K

Suction superheat 10K

The grey area indicates the need for additional cooling (refer to application limits).

Refer to the full-load operating limits at 50Hz.

Performance data under different operating conditions can be found in the LEONARDO selection software by

Performance Parameters (SP*L, Refrigerant R407C)

SP2L030E								
Tc	30			40			54	
Te	Pf	Pa	Pf	Pa	Pf	Pa	Pf	Pa
-25	4.3	1.7	3.4	1.8	2.8	1.8	-	-
-20	5.7	2.1	4.6	2.2	3.7	2.3	3.5	2.3
-15	7.5	2.4	6.2	2.6	5.1	2.7	4.7	2.8
-10	9.6	2.6	8.2	2.9	6.8	3.1	6.3	3.2
-5	12.2	2.8	10.6	3.2	8.9	3.5	8.2	3.6

SP2L040E								
Tc	30			40			54	
Te	Pf	Pa	Pf	Pa	Pf	Pa	Pf	Pa
-25	5.2	2.0	4.1	2.1	3.4	2.1	-	-
-20	6.8	2.5	5.5	2.6	4.5	2.7	4.2	2.7
-15	8.9	2.8	7.4	3.1	6.1	3.2	5.6	3.3
-10	11.6	3.1	9.8	3.4	8.2	3.7	7.5	3.8
-5	14.7	3.3	12.7	3.8	10.7	4.1	9.9	4.3

SP2L050E								
Tc	30			40			54	
Te	Pf	Pa	Pf	Pa	Pf	Pa	Pf	Pa
-25	6.0	2.4	4.7	2.5	3.9	2.5	-	-
-20	7.9	2.9	6.4	3.0	5.2	3.1	4.9	3.2
-15	10.4	3.3	8.6	3.5	7.1	3.8	6.5	3.8
-10	13.5	3.6	11.4	4.0	9.5	4.3	8.8	4.4
-5	17.1	3.9	14.8	4.4	12.4	4.8	11.5	5.0

SP2L060E								
Tc	30			40			54	
Te	Pf	Pa	Pf	Pa	Pf	Pa	Pf	Pa
-25	6.9	2.7	5.4	2.8	4.5	2.8	-	-
-20	9.1	3.2	7.3	3.5	6.0	3.6	5.5	3.6
-15	11.9	3.7	9.9	4.0	8.1	4.3	7.5	4.3
-10	15.4	4.1	13.1	4.5	10.9	4.9	10.0	5.0
-5	19.6	4.4	16.9	5.0	14.2	5.5	13.2	5.6

SP4LF060E/SP4LN060E								
Tc	30			40			54	
Te	Pf	Pa	Pf	Pa	Pf	Pa	Pf	Pa
-25	8.6	3.9	6.8	4.4	5.6	4.9	-	-
-20	11.4	4.4	9.2	5.1	7.5	5.6	7.0	5.8
-15	14.9	4.9	12.4	5.6	10.2	6.4	9.4	6.7
-10	19.3	5.3	16.3	6.2	13.6	7.1	12.5	7.4
-5	24.5	5.6	21.1	6.6	17.8	7.7	16.5	8.1

SP4LF080E/SP4LN080E								
Tc	30			40			54	
Te	Pf	Pa	Pf	Pa	Pf	Pa	Pf	Pa
-25	10.3	4.7	8.1	5.3	6.7	5.8	-	-
-20	13.6	5.3	11.0	6.1	9.0	6.8	8.4	7.0
-15	17.9	5.8	14.8	6.8	12.2	7.7	11.2	8.0
-10	23.1	6.3	19.6	7.4	16.3	8.5	15.0	8.9
-5	29.4	6.7	25.3	7.9	21.3	9.2	19.8	9.7

SP4LF100E/SP4LN100E								
Tc	30			40			54	
Te	Pf	Pa	Pf	Pa	Pf	Pa	Pf	Pa
-25	12.1	5.5	9.5	6.2	7.8	6.8	7.4	7.0
-20	15.9	6.2	12.9	7.1	10.5	7.9	9.7	8.2
-15	20.9	6.8	17.3	7.9	14.2	8.9	13.1	9.3
-10	27.0	7.4	22.9	8.6	19.0	9.9	17.6	10.4
-5	34.3	7.8	29.6	9.3	24.9	10.8	23.1	11.4

SP4LF120E/SP4LN120E								
Tc	30			40			54	
Te	Pf	Pa	Pf	Pa	Pf	Pa	Pf	Pa
-25	13.8	6.2	10.9	7.1	9.0	7.8	-	-
-20	18.2	7.0	14.7	8.1	12.0	9.0	11.1	9.4
-15	23.9	7.8	19.8	9.0	16.3	10.2	15.0	10.7
-10	30.9	8.4	26.2	9.8	21.7	11.3	20.1	11.9
-5	39.2	9.0	33.8	10.6	28.5	12.3	26.3	13.0

SP4L150E								
Tc	30			40			54	
Te	Pf	Pa	Pf	Pa	Pf	Pa	Pf	Pa
-25	15.9	7.2	12.5	8.2	10.3	9.0	-	-
-20	21.0	8.1	17.0	9.4	13.9	10.4	12.9	10.8
-15	27.6	9.0	22.9	10.4	18.8	11.8	17.3	12.3
-10	35.7	9.7	30.2	11.4	25.1	13.0	23.2	13.7
-5	45.3	10.3	39.0	12.2	32.9	14.2	30.4	15.0

SP4L180E								
Tc	30			40			54	
Te	Pf	Pa	Pf	Pa	Pf	Pa	Pf	Pa
-25	18.5	8.4	14.6	9.5	12.0	10.4	-	-
-20	24.3	9.4	19.7	10.9	16.1	12.1	14.9	12.5
-15	32.0	10.4	26.5	12.1	21.8	13.7	20.1	14.3
-10	41.4	11.3	35.0	13.2				

Performance Parameters (SP*L, Refrigerant R407C)

SP4L220E										
Tc	30			40			50			54
Te	Pf	Pa	Pf	Pa	Pf	Pa	Pf	Pa	Pf	Pa
-25	21.2	9.6	16.7	10.9	13.8	11.9	-	-	-	-
-20	27.9	10.8	22.6	12.5	18.4	13.9	17.1	14.4	-	-
-15	36.7	11.9	30.4	13.9	25.0	15.7	23.0	16.4	-	-
-10	47.4	12.9	40.2	15.1	33.4	17.4	30.8	18.2	-	-
-5	60.2	13.8	51.9	16.2	43.7	18.9	40.5	20.0	-	-

SP4L250E										
Tc	30			40			50			54
Te	Pf	Pa	Pf	Pa	Pf	Pa	Pf	Pa	Pf	Pa
-25	25.5	11.5	20.1	13.2	16.6	14.4	-	-	-	-
-20	33.6	13.0	27.2	15.0	22.2	16.7	20.6	17.3	-	-
-15	44.1	14.4	36.6	16.7	30.0	18.9	27.7	19.7	-	-
-10	57.1	15.5	48.3	18.2	40.2	20.9	37.1	21.9	-	-
-5	72.4	16.6	62.5	19.5	52.6	22.7	48.7	24.0	-	-

SP6L270E										
Tc	30			40			50			54
Te	Pf	Pa	Pf	Pa	Pf	Pa	Pf	Pa	Pf	Pa
-25	27.7	12.5	21.8	14.3	18.0	15.6	-	-	-	-
-20	36.5	14.2	29.5	16.3	24.1	18.2	22.4	18.8	-	-
-15	48.0	15.6	39.8	18.1	32.7	20.5	30.1	21.4	-	-
-10	62.0	16.9	52.6	19.8	43.7	22.7	40.3	23.9	-	-
-5	78.8	18.0	67.9	21.3	57.2	24.7	53.0	26.1	-	-

SP6L300E										
Tc	30			40			50			54
Te	Pf	Pa	Pf	Pa	Pf	Pa	Pf	Pa	Pf	Pa
-25	31.9	14.4	25.1	16.4	20.7	17.9	-	-	-	-
-20	42.0	16.3	33.9	18.7	27.7	20.9	25.7	21.6	-	-
-15	55.1	18.0	45.7	20.8	37.5	23.6	34.6	24.6	-	-
-10	71.3	19.4	60.4	22.7	50.2	26.1	46.4	27.4	-	-
-5	90.5	20.7	78.1	24.4	65.8	28.4	60.9	30.0	-	-

SP6L400E										
Tc	30			40			50			54
Te	Pf	Pa	Pf	Pa	Pf	Pa	Pf	Pa	Pf	Pa
-25	38.2	17.3	30.1	19.7	24.8	21.5	-	-	-	-
-20	50.4	19.5	40.7	22.5	33.2	25.0	30.9	25.9	-	-
-15	66.2	21.6	54.9	25.0	45.1	28.3	41.6	29.5	-	-
-10	85.6	23.3	72.5	27.3	60.3	31.3	55.6	32.9	-	-
-5	108.6	24.8	93.7	29.3	78.9	34.1	73.0	36.0	-	-

SP8L500E										
Tc	30			40			50			54
Te	Pf	Pa	Pf	Pa	Pf	Pa	Pf	Pa	Pf	Pa
-25	46.7	20.3	41.5	21.5	33.0	21.8	-	-	-	-
-20	62.6	23.4	55.7	25.2	45.9	26.2	41.5	26.4	-	-
-15	81.1	26.1	72.3	28.6	60.7	30.4	55.7	30.9	-	-
-10	102.7	28.5	91.6	31.8	77.9	34.4	72.2	35.3	-	-
-5	127.9	30.6	114.1	34.7	98.2	38.2	91.6	39.5	-	-

SP8L600E										
Tc	30			40			50			54
Te	Pf	Pa	Pf	Pa	Pf	Pa	Pf	Pa	Pf	Pa
-25	55.7	24.2	49.5	25.6	39.4	26.0	-	-	-	-
-20	74.7	27.9	66.5	30.0	54.7	31.3	49.5	31.5	-	-
-15	96.8	31.2	86.3	34.1	72.4	36.3	66.4	36.9	-	-
-10	122.6	34.1	109.3	37.9	93.0	41.1	86.2	42.1	-	-
-5	152.6	36.5	136.2	41.4	117.2	45.7	109.3	47.1	-	-

Key:

Pf = Refrigerant capacity (kW)

Pa = Input power (kW)

Te =Evaporating temperature (°C)

Tc =Condensing temperature(°C)

50Hz = Frequency

Liquid sub cooling 5K

Suction superheat 10K

The grey area indicates the need for additional cooling (refer to application limits).

Refer to the full-load operating limits at 50Hz.

Performance data under different operating conditions can be found in the LEONARDO selection software by

Performance Parameters (SP*H, Refrigerant R507A)

SP2H050E										
Tc	30			40			50			55
Te	Pf	Pa	Pf	Pa	Pf	Pa	Pf	Pa	Pf	Pa
-25	6.1	3.0	4.9	3.0	3.6	2.9	-	-	-	-
-20	7.8	3.2	6.3	3.4	4.8	3.4	-	-	-	-
-15	9.7	3.5	8.0	3.7	6.2	3.8	5.2	3.8	-	-
-10	11.9	3.6	10.0	4.0	7.9	4.2	6.7	4.2	-	-
-5	14.5	3.8	12.3	4.2	9.9	4.5	8.6	4.6	-	-
0	17.4	3.9	15.0	4.4	12.2	4.8	10.7	4.9	-	-
5	20.7	3.9	17.9	4.6	14.8	5.1	13.1	5.3	-	-

SP2H060E										
Tc	30			40			50			55
Te	Pf	Pa	Pf	Pa	Pf	Pa	Pf	Pa	Pf	Pa
-25	7.3	3.5	5.9	3.6	4.4	3.5	-	-	-	-
-20	9.3	3.9	7.6	4.1	5.7	4.1	-	-	-	-
-15	11.6	4.1	9.6	4.4	7.4	4.6	6.3	4.5	-	-
-10	14.3	4.4	12.0	4.8	9.4	5.0	8.1	5.0	-	-
-5	17.4	4.5	14.8	5.1	11.8	5.4	10.3	5.5	-	-
0	20.9	4.6	17.9	5.3	14.6	5.8	12.8	5.9	-	-
5	24.8	4.7	21.5	5.5	17.8	6.1	15.8	6.3	-	-

SP2H080E										
Tc	30			40			50			55
Te	Pf	Pa	Pf	Pa	Pf	Pa	Pf	Pa	Pf	Pa
-25	8.6	4.1	6.9	4.2	5.1	4.1	-	-	-	-
-20	10.9	4.5	8.8	4.7	6.7	4.7	-	-	-	-
-15	13.6	4.8	11.2	5.2	8.6	5.3	7.3	5.3	-	-
-10	16.7	5.1	14.0	5.6	11.0	5.8	9.4	5.9	-	-
-5	20.3	5.3	17.2	5.9	13.8	6.3	12	6.4	-	-
0	24.4	5.4	20.9	6.2	17.0	6.7	15	6.9	-	-
5	28.9	5.5	25.1	6.4	20.7	7.1	18.4	7.4	-	-

SP2H090E										
Tc	30			40			50			55
Te	Pf	Pa	Pf	Pa	Pf	Pa	Pf	Pa	Pf	Pa
-25	9.3	4.6	7.6	4.8	6.0	5.0	-	-	-	-
-20	12.1	5.0	9.9	5.4	7.8	5.7	-	-	-	-
-15	15.6	5.4	12.9	5.9	10.2	6.4	8.8	6.6	-	-
-10	19.8	5.7	16.6	6.4	13.3	7.0	11.6	7.3	-	-
-5	24.9	5.9	21.0	6.8	17.1	7.6	15.0	7.9	-	-
0	30.6	6.0	26.1	7.1	21.5	8.1	19.0	8.5	-	-
5	37.0	6.1	31.8	7.3	26.4	8.5	23.6	9.0	-	-

SP4HF100E/SP4HN100E										
Tc	30			40			50			55
Te	Pf	Pa	Pf	Pa	Pf	Pa	Pf	Pa	Pf	Pa
-25	11.8	5.4	9.6	5.6	7.2	5.6	-	-	-	-
-20	15.1	6.0	12.4	6.3	9.5	6.5	-	-	-	-
-15	18.9	6.5	15.8	7.0	12.3	7.3	10.4	7.4	-	-
-10	23.5	6.9	19.8	7.7	15.7	8.1	13.5	8.3	-	-
-5	28.6	7.3	24.4	8.2	19.6	8.9	17.1	9.1	-	-
0	34.5	7.6	29.7	8.7	24.3	9.5	21.3	9.8	-	-
5	41.2	7.8	35.7	9.1	29.5	10.1	26.2	10.5	-	-

SP4HF120E/SP4HN120E										
Tc	30			40			50			55
Te	Pf	Pa	Pf	Pa	Pf	Pa	Pf	Pa	Pf	Pa
-25	14.2	6.4	11.5	6.7	8.6	6.7	-	-	-	-
-20	18.1	7.2	14.9	7.6	11.4	7.8	-	-	-	-
-15	22.7	7.8	18.9	8.4	14.7	8.8	12.5	8.9	-	-
-10	28.1	8.3	23.7	9.2	18.8	9.8	16.2	9.9	-	-
-5	34.4	8.8	29.3	9.9	23.6	10.6	20.5	10.9	-	-
0	41.4	9.1	35.6	10.4	29.1	11.4	25.6	11.8	-	-
5	49.4	9.4	42.8	10.9	35.4	12.1	31.5	12.6	-	-

SP4HF150E/SP4HN150E										
Tc	30			40			50			55
Te	Pf	Pa	Pf	Pa	Pf	Pa	Pf	Pa	Pf	Pa
-25	16.6	7.5	13.5	7.8	10.1	7.8	-	-	-	-
-20	21.1	8.4	17.4	8.9	13.3	9.1	-	-	-	-
-15	26.5	9.1	22.1	9.8	17.2	10.3	14.6	10.4	-	-
-10	32.8	9.7	27.7	10.7	21.9	11.4	18.9	11.6	-	-
-5	40.1	10.2	34.1	11.5	27.5	12.4	24.0	12.7	-	-
0	48.3	10.7	41.6	12.2	34.0	13.3	29.9	13.8	-	-
5	57.6	11.0	49.9	12.8	41.4	14.2	36.7	14.7	-	-

Performance Parameters (SP*H, Refrigerant R507A)

SP4H300E									
Tc	30			40			50		55
Te	Pf	Pa	Pf	Pa	Pf	Pa	Pf	Pa	
-25	29.0	13.1	23.5	13.9	18.0	14.6	-	-	
-20	36.6	14.5	30.4	15.7	23.8	16.7	-	-	
-15	45.9	15.8	38.7	17.3	30.9	18.6	26.8	19.3	
-10	56.9	16.9	48.5	18.7	39.4	20.4	34.5	21.2	
-5	69.7	17.7	60.0	20.0	49.3	22.1	43.5	23.1	
0	84.5	18.4	73.2	21.1	60.7	23.6	53.9	24.9	
5	101.2	19.0	88.2	22.1	73.7	25.0	65.8	26.5	

SP4H350E									
Tc	30			40			50		55
Te	Pf	Pa	Pf	Pa	Pf	Pa	Pf	Pa	
-25	35.0	15.8	28.4	16.7	21.6	17.5	-	-	
-20	44.1	17.5	36.6	18.8	28.6	20.0	-	-	
-15	55.2	19.0	46.5	20.8	37.1	22.3	32.2	23.1	
-10	68.3	20.2	58.3	22.4	47.2	24.5	41.3	25.5	
-5	83.6	21.3	72.0	23.9	59.0	26.4	52.1	27.7	
0	101.2	22.1	87.7	25.3	72.6	28.3	64.5	29.7	
5	121.1	22.7	105.6	26.4	88.1	30.0	78.7	31.7	

SP6H370E									
Tc	30			40			50		55
Te	Pf	Pa	Pf	Pa	Pf	Pa	Pf	Pa	
-25	37.9	17.1	30.8	18.1	23.6	19.1	-	-	
-20	47.9	19.0	39.7	20.5	31.1	21.8	-	-	
-15	60.0	20.7	50.6	22.6	40.4	24.3	35.1	25.2	
-10	74.4	22.0	63.5	24.4	51.5	26.7	45.1	27.8	
-5	91.2	23.2	78.5	26.1	64.4	28.9	56.9	30.2	
0	110.5	24.1	95.8	27.6	79.4	30.9	70.5	32.5	
5	132.4	24.8	115.4	28.9	96.4	32.8	86.1	34.7	

SP6H400E									
Tc	30			40			50		55
Te	Pf	Pa	Pf	Pa	Pf	Pa	Pf	Pa	
-25	43.6	19.7	35.4	20.9	27.1	21.9	-	-	
-20	55.0	21.9	45.6	23.5	35.8	25.1	-	-	
-15	69.0	23.7	58.1	26.0	46.5	28.0	40.3	29.0	
-10	85.5	25.3	73.0	28.1	59.2	30.7	51.9	32.0	
-5	104.9	26.7	90.3	30.0	74.1	33.2	65.4	34.7	
0	127.1	27.7	110.1	31.7	91.2	35.5	81.1	37.4	
5	152.2	28.5	132.7	33.2	110.8	37.7	99.0	39.9	

SP6H500E									
Tc	30			40			50		55
Te	Pf	Pa	Pf	Pa	Pf	Pa	Pf	Pa	
-25	52.4	23.6	42.5	25.0	32.5	26.2	-	-	
-20	66.1	26.3	54.8	28.3	42.9	30	-	-	
-15	82.7	28.5	69.8	31.1	55.7	33.5	48.3	34.7	
-10	102.5	30.4	87.5	33.7	70.9	36.7	62.1	38.2	
-5	125.6	31.9	108.1	36.0	88.6	39.7	78.2	41.6	
0	152.0	33.2	131.8	38.0	109.1	42.5	96.9	44.7	
5	182.0	34.1	158.6	39.7	132.4	45.0	118.3	47.6	

SP8H600E									
Tc	30			40			50		55
Te	Pf	Pa	Pf	Pa	Pf	Pa	Pf	Pa	
-25	68.0	29.0	49.5	29.5	37.4	29.2	-	-	
-20	83.6	31.8	64.1	33.3	50.1	33.9	-	-	
-15	102.2	34.5	81.3	37.0	64.9	38.7	56.9	38.9	
-10	124.2	36.8	101.5	40.6	82.4	43.4	72.6	44.2	
-5	150.1	38.9	125.0	43.9	102.7	48.0	91.1	49.5	
0	180.1	40.4	152.3	46.9	126.4	52.4	112.6	54.7	
5	214.7	41.5	183.7	49.5	153.8	56.7	137.7	59.7	

SP8H700E									
Tc	30			40			50		55
Te	Pf	Pa	Pf	Pa	Pf	Pa	Pf	Pa	
-25	81.1	34.6	59.1	35.3	44.6	34.8	-	-	
-20	99.7	38.0	76.5	39.8	59.8	40.5	-	-	
-15	122.0	41.2	97.0	44.2	77.5	46.1	67.9	46.5	
-10	148.3	44.0	121.1	48.4	98.3	51.8	86.7	52.8	
-5	179.1	46.4	149.2	52.4	122.6	57.3	108.7	59.1	
0	215.0	48.3	181.8	56.0	150.9	62.6	134.4	65.3	
5	256.3	49.6	219.3	59.1	183.6	67.6	164.4	71.3	

Key:

Pf = Refrigerant capacity (kW)

Pa = Input power (kW)

Te =Evaporating temperature (°C)

Tc =Condensing temperature(°C)

50Hz = Frequency

Liquid sub cooling 5K

Suction superheat 10K

The grey area indicates the need for additional cooling (refer to application limits).

Refer to the full-load operating limits at 50Hz.

Performance data under different operating conditions can be found in the LEONARDO selection software by

Performance Parameters (SP*L, Refrigerant R507A)

SP2L030E									
Tc	30			40			50		52
Te	Pf	Pa	Pf	Pa	Pf	Pa	Pf	Pa	
-40	2.5	1.9	1.9	1.9	1.4	1.8	-	-	
-35	3.5	2.3	2.8	2.3	2.1	2.3	-	-	
-30	4.7	2.6	3.8	2.6	2.9	2.7	2.7	2.7	
-25	6.1	2.9	4.9	3	3.8	3.2	3.6	3.2	
-20	7.7	3.2	6.3	3.4	5	3.6	4.7	3.6	
-15	9.6	3.4	8	3.8	6.4	4	6.1	4.1	
-10	11.9	3.6	10	4.1	8.2	4.5	7.8	4.6	
-6	14.1	3.8	12	4.3	9.9	4.8	-	-	

SP2L040E									
Tc	30			40			50		52
Te	Pf	Pa	Pf	Pa	Pf	Pa	Pf	Pa	
-40	3	2.3	2.2	2.2	1.6	2.2	-	-	
-35	4.3	2.7	3.3	2.7	2.5	2.7	-	-	
-30	5.7	3.1	4.5	3.2	3.5	3.2	3.3	3.2	
-25	7.3	3.5	5.9	3.6	4.6	3.8	4.4	3.8	
-20	9.2	3.8	7.5	4.1	6	4.3	5.7	4.3	
-15	11.5	4.1	9.5	4.5	7.7	4.8	7.3	4.9	
-10	14.2	4.4	12	4.9	9.8	5.3	9.3	5.4	
-6	16.9	4.5	14.3	5.2	11.8	5.8	-	-	

SP2L050E									
Tc	30			40			50		52
Te	Pf	Pa	Pf	Pa	Pf	Pa	Pf	Pa	
-40	3.5	2.6	2.6	2.6	1.9	2.5	-	-	
-35	5	3.1	3.9	3.1	2.9	3.1	-	-	
-30	6.6	3.6	5.3	3.7	4.1	3.7	3.8	3.8	
-25	8.5	4	6.9	4.2	5.4	4.4	5.1	4.4	
-20	10.7	4.4	8.8	4.7	7	5	6.6	5	
-15	13.4	4.7	11.1	5.2	8.9	5.6	8.5	5.7	
-10	16.6	5.1	14	5.7	11.4	6.2	10.9	6.3	
-6	19.7	5.3	16.7	6	13.8	6.7	-	-	

SP2L060E									
Tc	30			40			50		52
Te	Pf	Pa	Pf	Pa	Pf	Pa	Pf	Pa	
-40	4	3	3	2.9	2.2	2.9	-	-	
-35	5.7	3.6	4.4	3.6	3.4	3.6	-	-	
-30	7.6	4.1	6	4.2	4.6	4.3	4.4	4.3	
-25	9.7	4.6	7.9	4.8	6.1	5	5.8	5	
-20	12.3	5	10.1	5.4	8	5.7	7.5	5.7	
-15	15.3	5.4	12.7	5.9	10.2	6.4	9.7	6.5	
-10	19	5.7	16	6.4	13	7.1	12.5	7.2	
-6	22.5	6	19.1	6.8	15.8	7.6	-	-	

SP4LF060E/SP4LN060E									
Tc	30			40			50		52
Te	Pf	Pa	Pf	Pa	Pf	Pa	Pf	Pa	
-40	5.2	3.4	4.0	3.4	2.7	3.3	-	-	
-35	6.9	4.0	5.4	4.1	3.8	4.2	-	-	
-30	9.2	4.6	7.3	4.9	5.3	5.1	5.0	5.1	
-25	11.9	5.2	9.7	5.6	7.4	6.0	6.9	6.1	
-20	15.1	5.8	12.5	6.3	9.9	6.8	9.4	6.9	
-15	18.8	6.4	15.9	7.0	12.9	7.7	12.3	7.8	
-10	23.0	6.9	19.8	7.7	16.4	8.5	15.7	8.7	
-6	26.8	7.3	23.2	8.2	19.5	9.1	-	-	

SP4LF080E/SP4LN080E									
Tc	30			40			50		52
Te	Pf	Pa	Pf	Pa	Pf	Pa	Pf	Pa	
-40	6.2	4.1	4.8	4.0	3.3	4.0	-	-	
-35	8.3	4.8	6.5	4.9	4.6	5.1	-	-	
-30	11.0	5.6	8.7	5.8	6.4	6.1	5.9	6.2	
-25	14.3	6.3	11.6	6.7	8.9	7.2	8.3	7.3	
-20	18.1	7.0	15.0	7.6	11.9	8.2	11.2	8.3	
-15	22.6	7.7	19.1	8.4	15.5	9.2	14.8	9.4	
-10	27.7	8.3	23.7	9.2	19.7	10.2	18.8	10.4	
-6	32.1	8.8	27.8	9.9	23.4	11.0	-	-	

SP4LF100E/SP4LN100E									
Tc	30			40			50		52
Te	Pf	Pa	Pf	Pa	Pf	Pa	Pf	Pa	
-40	7.3	4.7	5.6	4.7	3.8	4.6	-	-	
-35	9.7	5.6	7.5	5.8	5.3	5.9	-	-	
-30	12.8	6.5	10.2	6.8	7.5	7.1	6.9	7.2	
-25	16.6	7.3	13.5	7.8	10.3	8.4	9.7	8.5	
-20	21.1	8.1	17.5	8.8	13.9	9.6	13.1	9.7	
-15	26.4	8.9	22.3	9.8	18.1	10.7	17.2	10.9	
-10	32.3	9.7	27.7	10.8	22.9	11.9	22.0	12.1	
-6	37.5	10.3	32.5	11.5	27.3	12.8	-	-	

SP4LF120E/SP4LN120E									
Tc	30			40			50		52
Te	Pf	Pa	Pf	Pa	Pf	Pa	Pf	Pa	
-40	8.3	5.4	6.4	5.4	4.4	5.3	-	-	
-35	11.1	6.4	8.6	6.6	6.1	6.7	-	-	
-30	14.6	7.4	11.6	7.8	8.6	8.2	7.9	8.2	
-25	19.0	8.4	15.5	9.0	11.8	9.6	11.1	9.7	
-20	24.2	9.3	20.1	10.1	15.8	10.9	15.0	11.1	
-15	30.1	10.2</							

Performance Parameters (SP*L, Refrigerant R507A)

SP4L220E								
Tc	30		40		50		52	
Te	Pf	Pa	Pf	Pa	Pf	Pa	Pf	Pa
-40	12.8	8.3	9.8	8.2	6.7	8.1	-	-
-35	17.0	9.9	13.3	10.1	9.3	10.4	-	-
-30	22.5	11.4	17.9	12.0	13.1	12.5	12.2	12.7
-25	29.2	12.9	23.8	13.8	18.1	14.7	17.0	14.9
-20	37.1	14.3	30.8	15.5	24.3	16.8	23.0	17.1
-15	46.3	15.7	39.1	17.2	31.7	18.9	30.2	19.2
-10	56.7	17.0	48.6	18.9	40.3	20.9	38.6	21.3
-6	65.9	18.0	57.0	20.2	48.0	22.5	-	-

SP4L250E								
Tc	30		40		50		52	
Te	Pf	Pa	Pf	Pa	Pf	Pa	Pf	Pa
-40	15.4	10.0	11.8	9.9	8.1	9.8	-	-
-35	20.5	11.9	15.9	12.2	11.2	12.5	-	-
-30	27.1	13.7	21.5	14.4	15.8	15.1	14.6	15.2
-25	35.1	15.5	28.6	16.6	21.8	17.7	20.5	17.9
-20	44.7	17.2	37.1	18.7	29.3	20.2	27.7	20.5
-15	55.7	18.9	47.0	20.7	38.2	22.7	36.4	23.1
-10	68.2	20.5	58.4	22.8	48.5	25.1	46.5	25.6
-6	79.2	21.7	68.6	24.3	57.8	27.1	-	-

SP6L270E								
Tc	30		40		50		52	
Te	Pf	Pa	Pf	Pa	Pf	Pa	Pf	Pa
-40	16.7	10.9	12.8	10.8	8.8	10.6	-	-
-35	22.3	12.9	17.3	13.3	12.2	13.5	-	-
-30	29.4	14.9	23.4	15.7	17.2	16.4	15.9	16.6
-25	38.2	16.9	31.1	18.0	23.7	19.2	22.3	19.5
-20	48.6	18.7	40.3	20.3	31.8	22.0	30.1	22.3
-15	60.6	20.5	51.1	22.6	41.5	24.7	39.5	25.1
-10	74.1	22.3	63.5	24.7	52.7	27.3	50.5	27.9
-6	86.2	23.6	74.6	26.4	62.8	29.4	-	-

SP6L300E								
Tc	30		40		50		52	
Te	Pf	Pa	Pf	Pa	Pf	Pa	Pf	Pa
-40	19.2	12.5	14.8	12.4	10.1	12.2	-	-
-35	25.6	14.9	19.9	15.2	14.0	15.6	-	-
-30	33.8	17.2	26.9	18.0	19.8	18.9	18.3	19.0
-25	43.9	19.4	35.7	20.7	27.3	22.1	25.6	22.4
-20	55.8	21.5	46.3	23.4	36.6	25.3	34.6	25.7
-15	69.6	23.6	58.8	25.9	47.7	28.4	45.5	28.9
-10	85.2	25.6	73.0	28.4	60.6	31.4	58.1	32.0
-6	99.0	27.1	85.8	30.4	72.2	33.8	-	-

SP6L400E								
Tc	30		40		50		52	
Te	Pf	Pa	Pf	Pa	Pf	Pa	Pf	Pa
-40	23.1	15.0	17.7	14.9	12.1	14.7	-	-
-35	30.7	17.8	23.9	18.3	16.8	18.7	-	-
-30	40.6	20.6	32.3	21.6	23.7	22.6	22.0	22.8
-25	52.7	23.2	42.9	24.9	32.8	26.5	30.7	26.9
-20	67.0	25.8	55.6	28.0	43.9	30.3	41.6	30.8
-15	83.5	28.3	70.5	31.1	57.2	34.1	54.6	34.7
-10	102.3	30.7	87.7	34.1	72.7	37.7	69.7	38.4
-6	118.8	32.5	102.9	36.5	86.6	40.6	-	-

SP8L500E								
Tc	30		40		50		52	
Te	Pf	Pa	Pf	Pa	Pf	Pa	Pf	Pa
-40	34.8	20.6	17.6	18.5	9.2	15.8	-	-
-35	43.8	22.8	26.6	21.6	17.3	19.7	-	-
-30	54.7	25.5	37.1	25.2	26.5	24.2	24.8	23.6
-25	67.8	28.4	49.4	29.1	37.2	29.1	35.0	28.8
-20	83.4	31.4	63.9	33.2	49.7	34.3	47.1	34.2
-15	101.9	34.2	81.0	37.3	64.5	39.6	61.3	39.7
-10	123.7	36.8	101.0	41.2	81.8	44.8	78.0	45.1
-6	143.8	38.5	119.4	44.0	97.8	48.7	-	-

SP8L600E								
Tc	30		40		50		52	
Te	Pf	Pa	Pf	Pa	Pf	Pa	Pf	Pa
-40	41.6	24.5	21.1	22.1	11.0	18.9	-	-
-35	52.3	27.2	31.8	25.8	20.7	23.5	-	-
-30	65.3	30.4	44.3	30.0	31.6	28.9	29.6	28.2
-25	80.9	33.9	59.0	34.7	44.4	34.8	41.8	34.4
-20	99.5	37.4	76.3	39.6	59.3	41.0	56.2	40.8
-15	121.6	40.9	96.7	44.5	76.9	47.3	73.1	47.4
-10	147.7	43.9	120.6	49.1	97.7	53.4	93.1	53.9
-6	171.7	46.0	142.6	52.5	116.7	58.2	-	-

Key:

Pf = Refrigerant capacity (kW)

Pa = Input power (kW)

Te =Evaporating temperature (°C)

Tc =Condensing temperature(°C)

50Hz = Frequency

Liquid sub cooling 5K

Suction superheat 10K

The grey area indicates the need for additional cooling (refer to application limits).

Refer to the full-load operating limits at 50Hz.

Performance data under different operating conditions can be found in the LEONARD0 selection software by

Product Supply

Standard accessories items:

- SP2 Star-connected motors (400V / 3 / 50Hz) or Delta-connected motors (230V / 3 / 50Hz);
- Part-winding start motors (400V / 3 / 50Hz or 460V / 3 / 60Hz);
- Crankcase Heater;
- Discharge shut-off valve;
- Suction shut-off valve;
- Spring vibration damper (Rubber vibration damper for SP2 and SP8);
- Direct on-line (DOL);
- Safety valve;
- Oil sight glass;
- Oil filter (for compressors with oil pump only);
- Oil charge;
- PTC Protective Thermistor;
- INT69 protection module (230V / 1 / 50 or 60Hz) (except for SP2);
- INT69B2 protection module (230V / 1 / 50 or 60Hz) (for models other than SP2);
- IP54 terminal box.

Optional accessories:

- SP2 Star-connected motors (400V / 3 / 50Hz) or Delta-connected motors (230V / 3 / 50Hz);
- Star-Delta started motors (400V / 3 / 50Hz or 460V / 3 / 60Hz);
- Special voltages motor;
- Oil pressure differential switch assembly (for forced lubricated compressors only);
- Photoelectric oil level switch assembly (for splash lubricated compressors only);
- CR capacity regulation assembly;
- SU start unloading assembly;
- Liquid spray kit (except SP2);
- Fan assembly (except SP8);
- Discharge temperature probe assembly;
- Oil charging valve;
- Compressor parallel connection connection;
- Special packaging.

Compressor Type	Energy Regulation Stage	Energy Regulation Point	Energy Regulation Stage	Energy Regulation Point
2缸	-	-	-	-
4缸	1	50%	-	-
6缸	1	66%	2	66%-33%
8缸	1	75%	2	75%-50%

The standard electrical specifications for the compressor's electronic accessories (electronic protection module, crankcase heater, CR, SU solenoid valve coil) are 230V AC 50/60Hz. For special voltage requirements, please consult RefComp.

SP2L0300/SP2L030E、SP2L0400/SP2L040E、
SP2L(H)0500/SP2L050E、SP2L(H)0600/SP2L060E

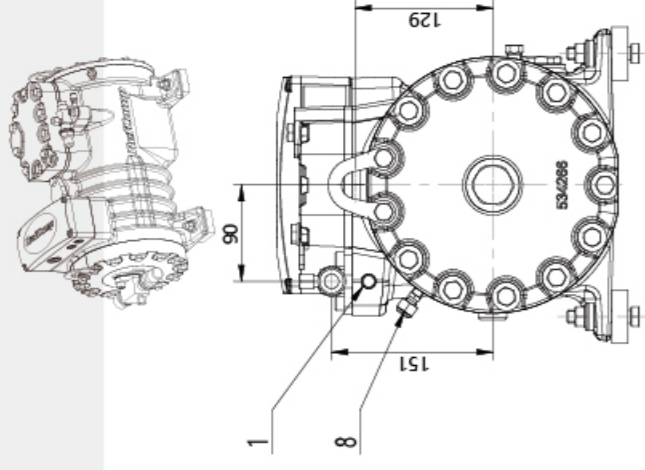
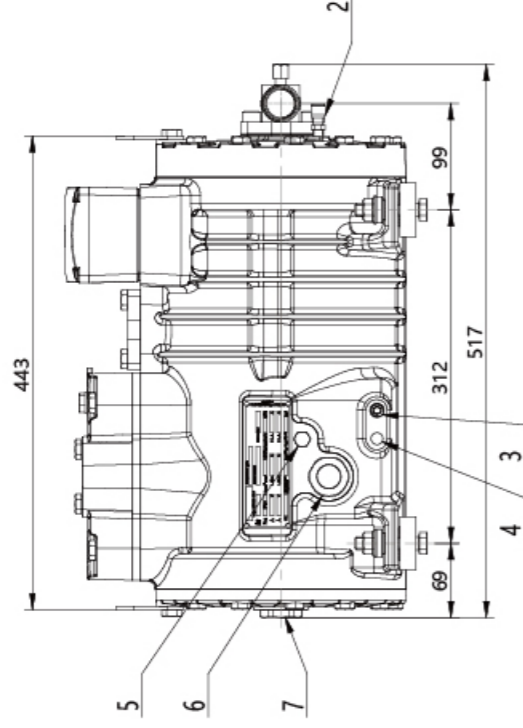
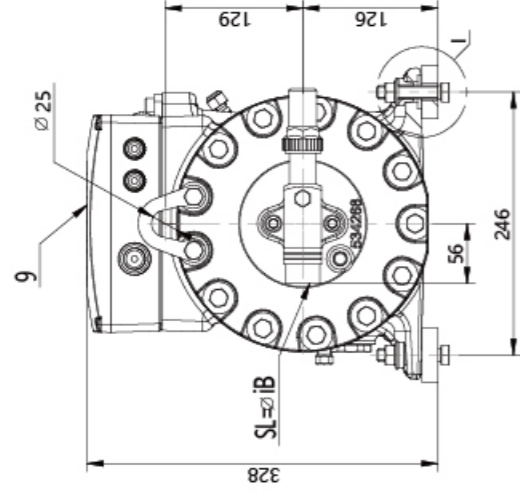

Serie/Type	
SP2L0300-SP2H0500	SP2L0500
SP2L0400-SP2H0600	SP2L0600
SL=Φ	28-1 1/8"
DL=Φ	16-5/8"
	22-7/8"

Key:

1	Suction shut-off valve SL
2	Discharge shut-off valve DL
3	Discharge temperature sensor valve 1/8" NPT (optional)
4	High-pressure connection 1/4" SAE-FLARE
5	Low-pressure connection 1/4" SAE-FLARE
6	Oil drain plug 1/4" NPT
7	Crankcase heater
8	Oil charging port shut-off valve 1/4" NPT
9	Oil sight glass
10	Oil level sensor (optional)

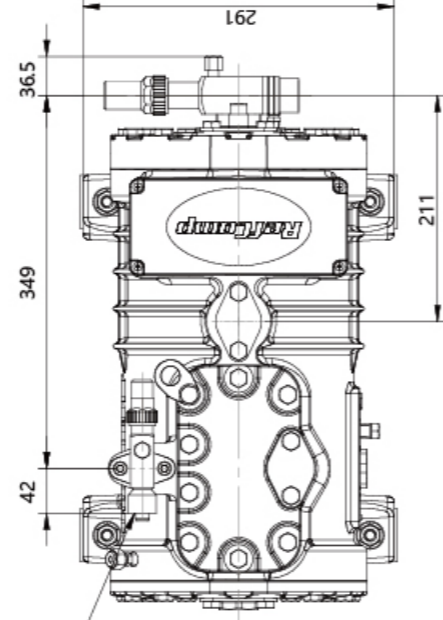

Rubber vibration isolator assembly DL=ΦIA

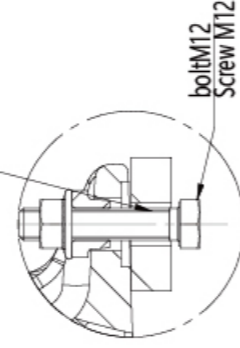

view I
DETAIL I
1:2

SP2H0800/SP2H080E、
SP2H0900/SP2H090E

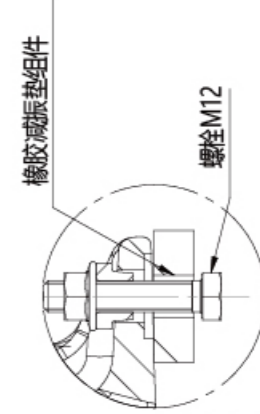
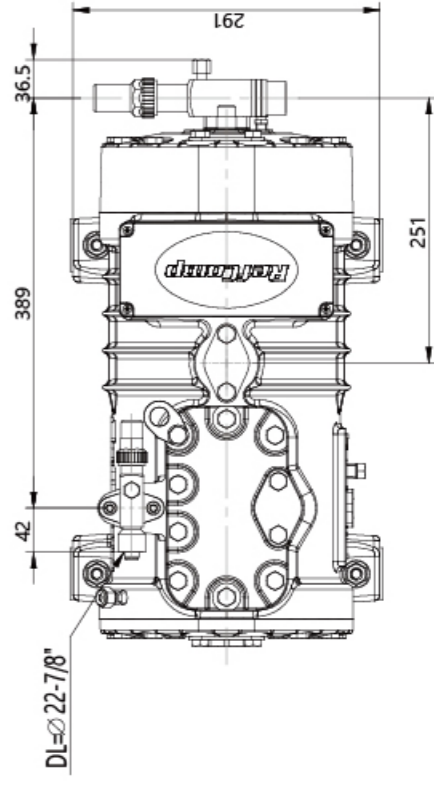
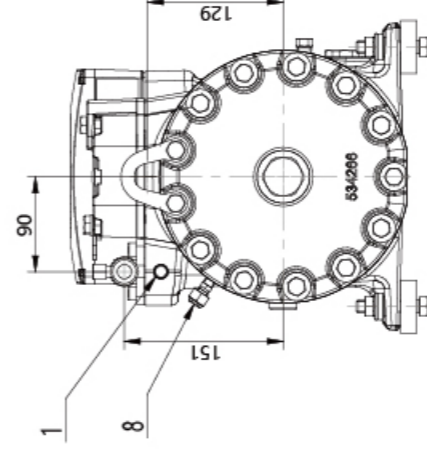
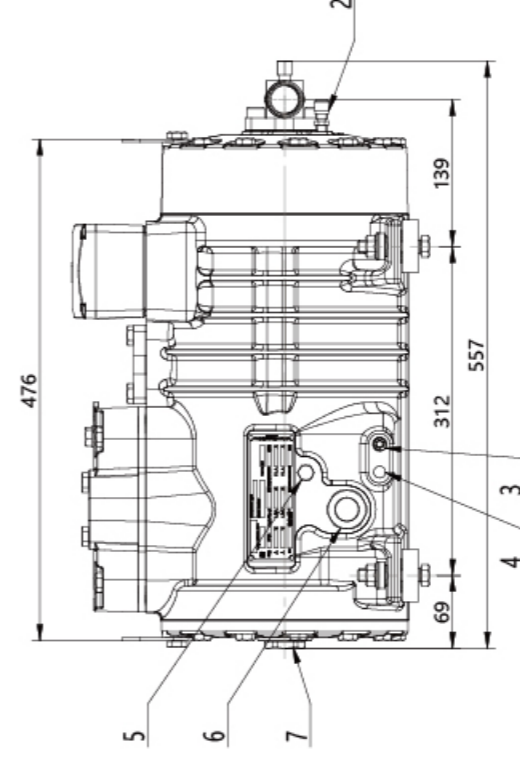
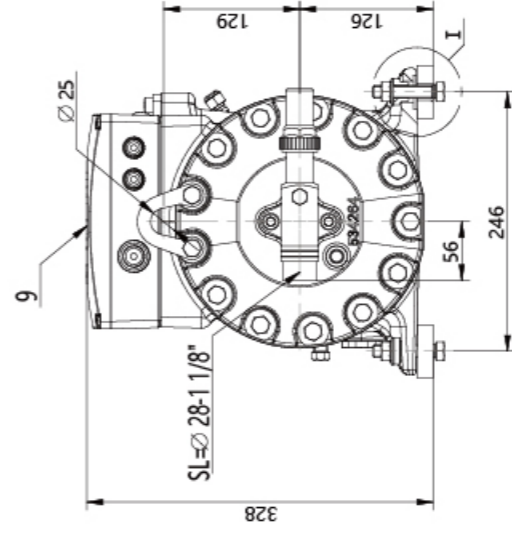

视图 I
DETAIL I
1:2

Key:

1	Suction shut-off valve SL
2	Discharge shut-off valve DL
3	Discharge temperature sensor valve 1/8" NPT (optional)
4	High-pressure connection 1/4" SAE-FLARE
5	Low-pressure connection 1/4" SAE-FLARE
6	Oil drain plug 1/4" NPT
7	Crankcase heater
8	Oil charging port shut-off valve 1/4" NPT
9	Oil sight glass
10	Oil level sensor (optional)

SP4LF0600/SP4LF060E, SP4LF0800/SP4LF080E,
SP4L(H)F1000/SP4L(H)F100E, SP4L(H)F1200/SP4L(H)F120E

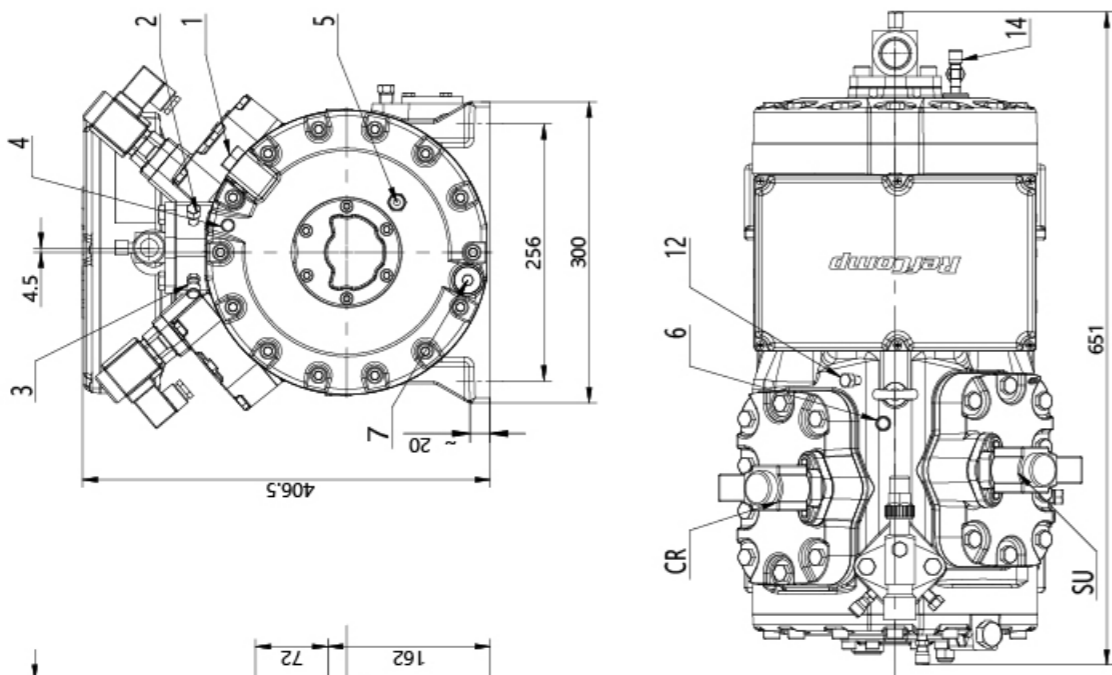

Series/Type	SP4LF0800-SP4HF1200	SP4LF1000-SP4LF1200
SL=Φ	28-1 1/8"	35-1 3/8"
DL=Φ	22-7/8"	28-1 1/8"

Key:

1	Suction shut-off valve(SL)
2	Discharge shut-off valve
3	Electrical oil pressure switch connection
4	Discharge temperature sensor 1/8" NPT
5	High-pressure connection 1/8" NPT
6	Oil high-pressure connection 1/4" SAE-FLARE
7	Oil low-pressure connection 1/4" SAE-FLARE
8	Low-pressure connection 1/8" NPT
9	Oil filter M22 x 1.5
10	Oil drain plug 3/8" NPT
11	Crankcase heater
12	Oil charging port 1/4" NPT
13	Oil level sight glass
14	LCM liquid injection connection 1/8" NPT
15	Terminal box
16	Low-pressure connection 1/4" SAE-FLARE

CR Capacity regulator
SU Start unloading device

SP4HF1500/SP4HF150E,
SP4HF2000/SP4HF200E

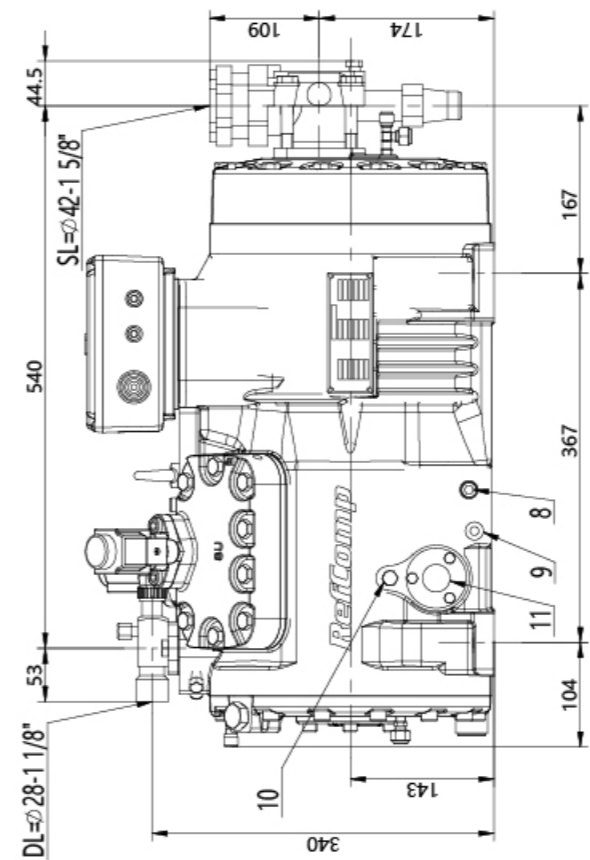
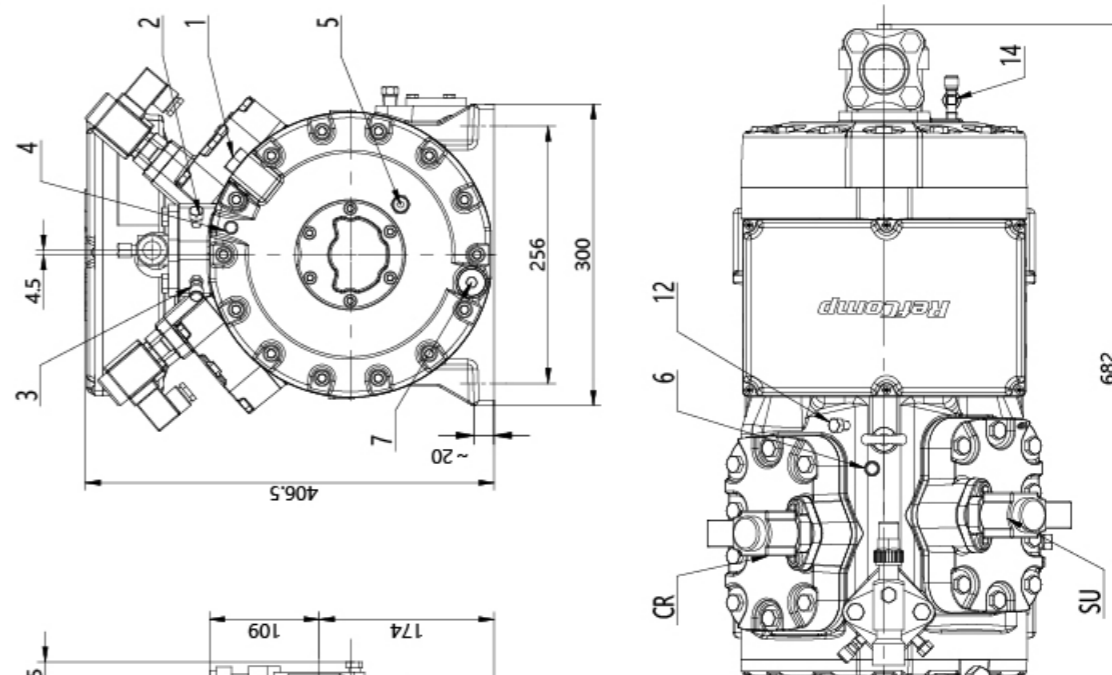

Key:

1	Suction shut-off valve(SL)
2	Discharge shut-off valve
3	Electrical oil pressure switch connection
4	Discharge temperature sensor 1/8" NPT
5	High-pressure connection 1/8" NPT
6	Oil high-pressure connection 1/4" SAE-FLARE
7	Oil low-pressure connection 1/4" SAE-FLARE
8	Low-pressure connection 1/8" NPT
9	Oil filter M22 x 1.5
10	Oil drain plug 3/8" NPT
11	Crankcase heater
12	Oil charging port 1/4" NPT
13	Oil level sight glass
14	LCM liquid injection connection 1/8" NPT
15	Terminal box
16	Low-pressure connection 1/4" SAE-FLARE

CR Capacity regulator
SU Start unloading device

SP4LN0600/SP4LN060E, SP4LN0800/SP4LN080E,
SP4L(H)N1000/SP4L(H)N100E, SP4L(H)N1200/SP4L(H)N120E

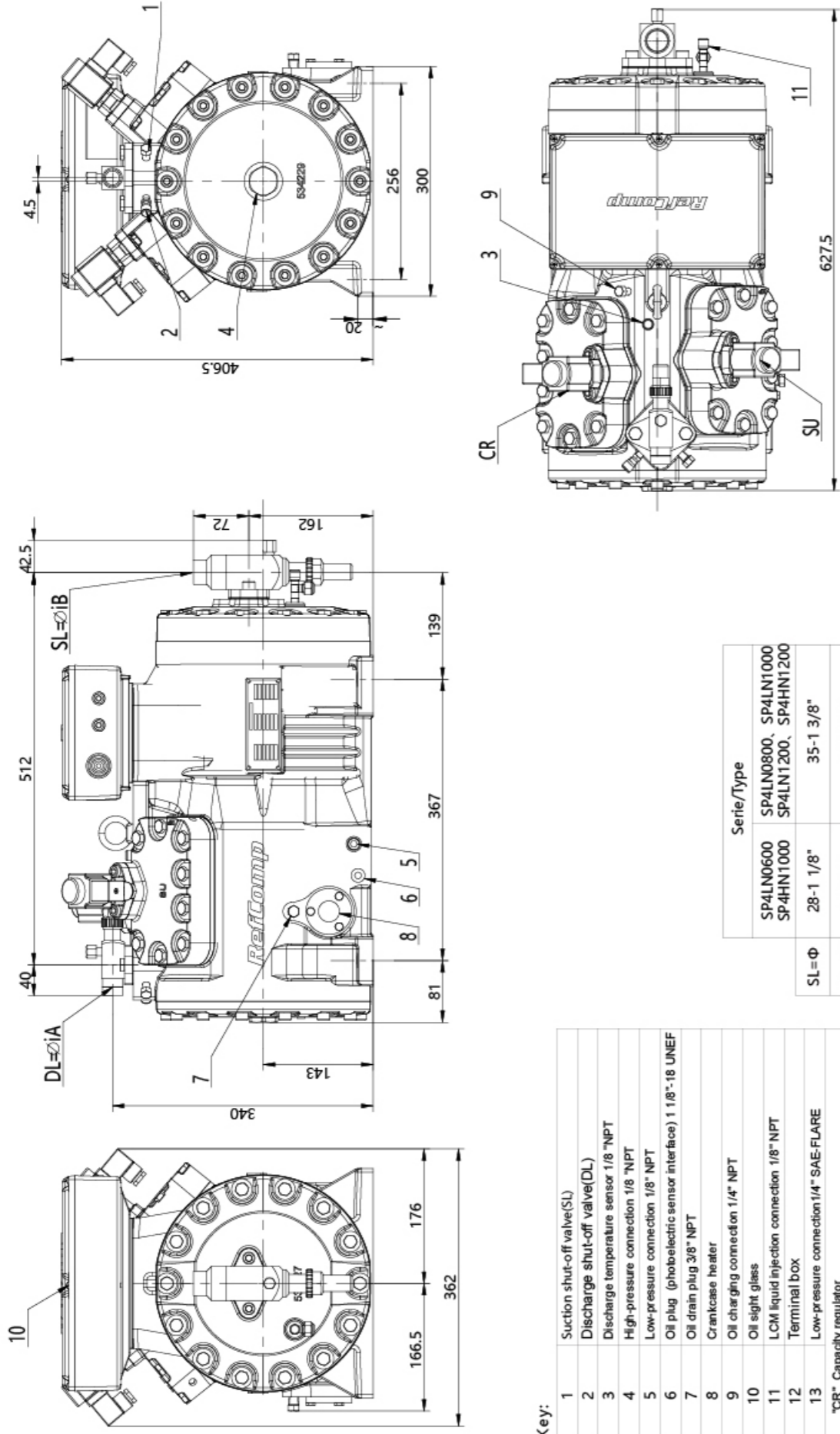

Key:

- Suction shut-off valve(SL)
- Discharge shut-off valve(DL)
- Discharge temperature sensor 1/8" NPT
- High-pressure connection 1/8" NPT
- Low-pressure connection 1/8" NPT
- Oil plug (photoelectric sensor interface) 1 1/8"-18 UNEF
- Oil drain plug 3/8" NPT
- Crankcase heater
- Oil charging connection 1/4" NPT
- Oil sight glass
- LCM liquid injection connection 1/8" NPT
- Terminal box
- Low-pressure connection 1/4" SAE-FLARE

CR Capacity regulator
SU Start unloading device

SP4HN1500/SP4HN150E,
SP4HN2000/SP4HN200E

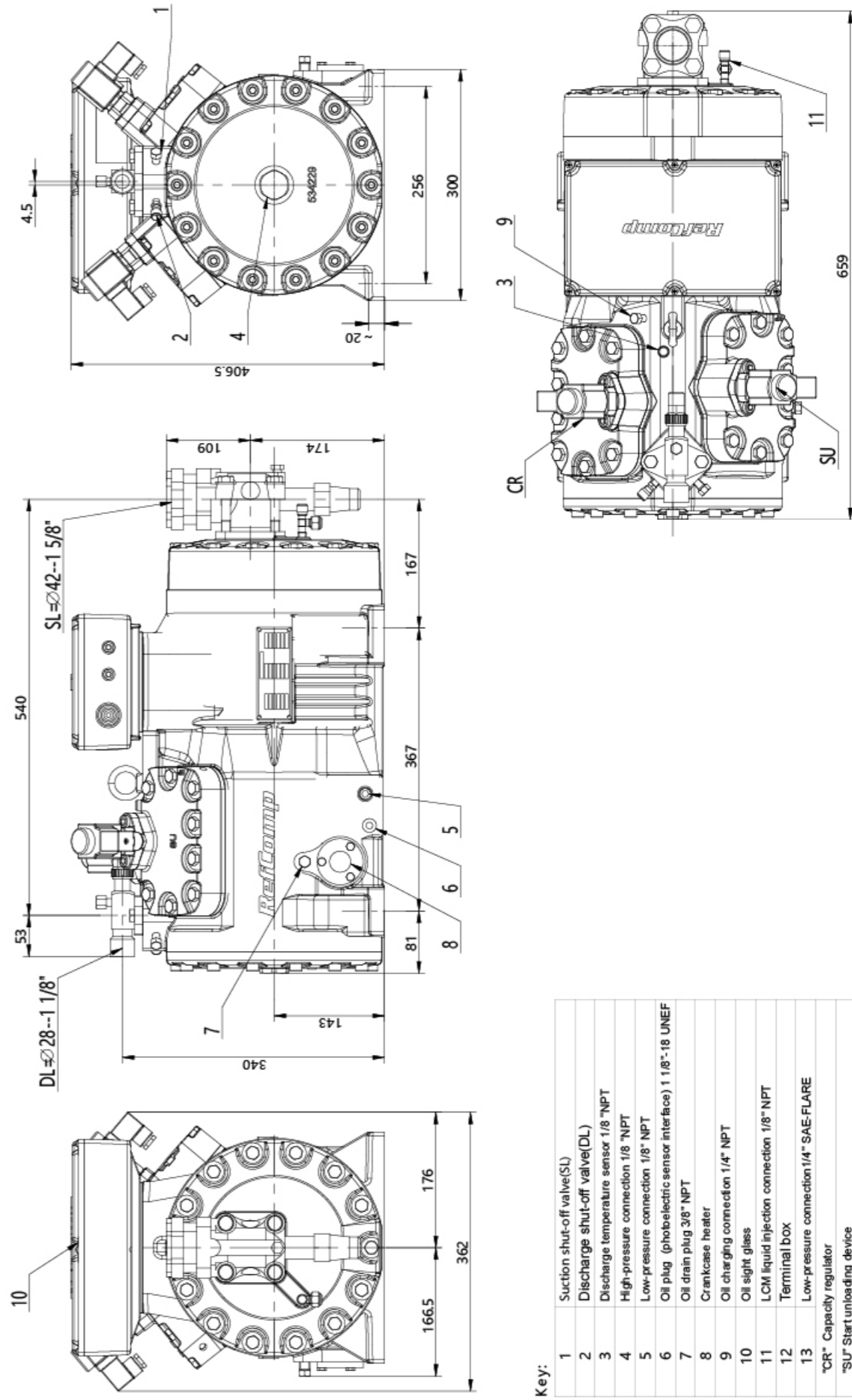

Key:

- Suction shut-off valve(SL)
- Discharge shut-off valve(DL)
- Discharge temperature sensor 1/8" NPT
- High-pressure connection 1/8" NPT
- Low-pressure connection 1/8" NPT
- Oil plug (photoelectric sensor interface) 1 1/8"-18 UNEF
- Oil drain plug 3/8" NPT
- Crankcase heater
- Oil charging connection 1/4" NPT
- Oil sight glass
- LCM liquid injection connection 1/8" NPT
- Terminal box
- Low-pressure connection 1/4" SAE-FLARE

CR Capacity regulator
SU Start unloading device

SP4L1500—SP4L2500/SP4L150E—SP4L250E;
 SP4H2200—SP4H3500/SP4H220E—SP4H350E

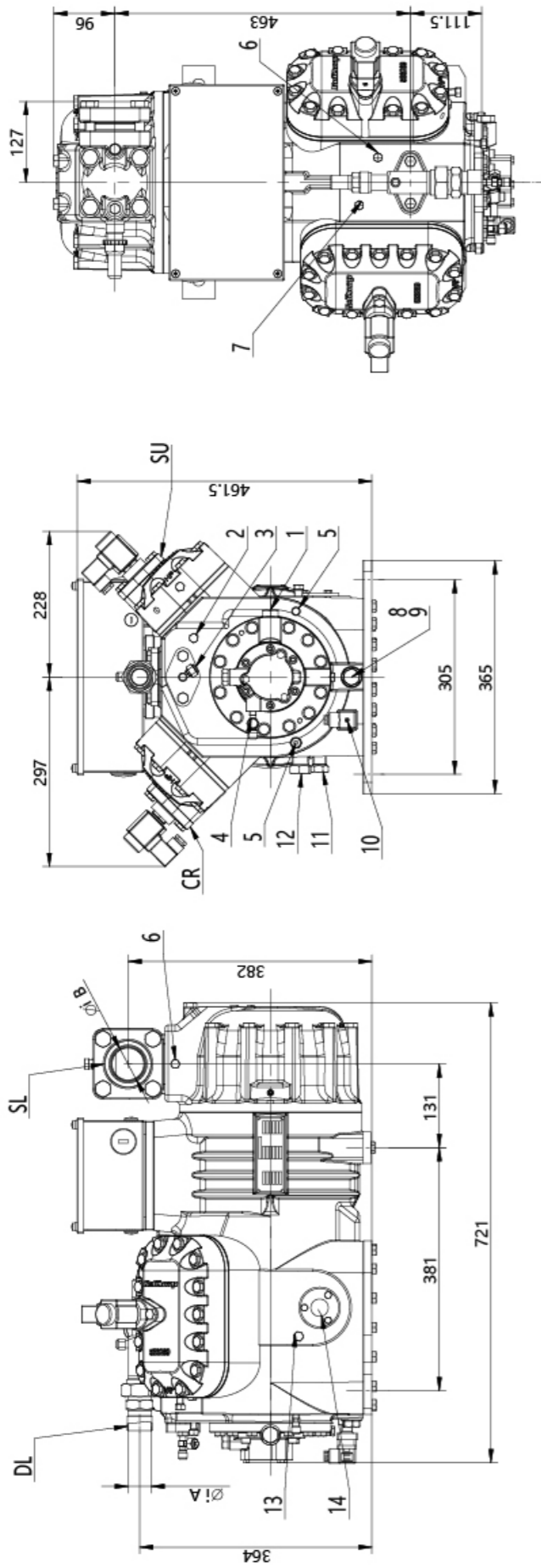

Key:

1	Electronic oil pressure switch connection
2	Discharge temperature sensor
3	High-pressure connection 1/4" SAE-FLARE
4	Oil high-pressure connection 1/4" SAE-FLARE
5	Oil low-pressure connection 1/4" SAE-FLARE
6	Low-pressure connection 1/8"NPT
7	Low-pressure connection 1/8"NPT (for liquid injection)
8	Oil filter
9	Oil drain plug
10	Crankcase heater
11	Connection for oil equalization (parallel operation)
12	Connection for gas equalization (parallel operation)
13	Oil chaming port 1/4" NPT

14	Oil sight glass
(DL)	Discharge shut-off valve
(SL)	Suction shut-off valve
(L1)	Solenoid valve level 1 (L2) Electromagnetic valve, Level 2
(L2)	Solenoid valve level 2
(SU)	Start/unload solenoid valve

SERIE P	ΦI A	ΦI B
SP4H2200/220E	28	42
SP4L1500/150E	28	42
SP4H2500/250E	28	54
SP4L1800/180E	28	42
SP4H3000/300E	28	54
SP4L2200/220E	28	54
SP4H3500/350E	35	54
SP4L2500/250E	35	54

SP6L2700—SP6L3000/SP6L270E—SP6L300E;
 SP6H3700—SP6H4000/SP6H370E—SP6L400E

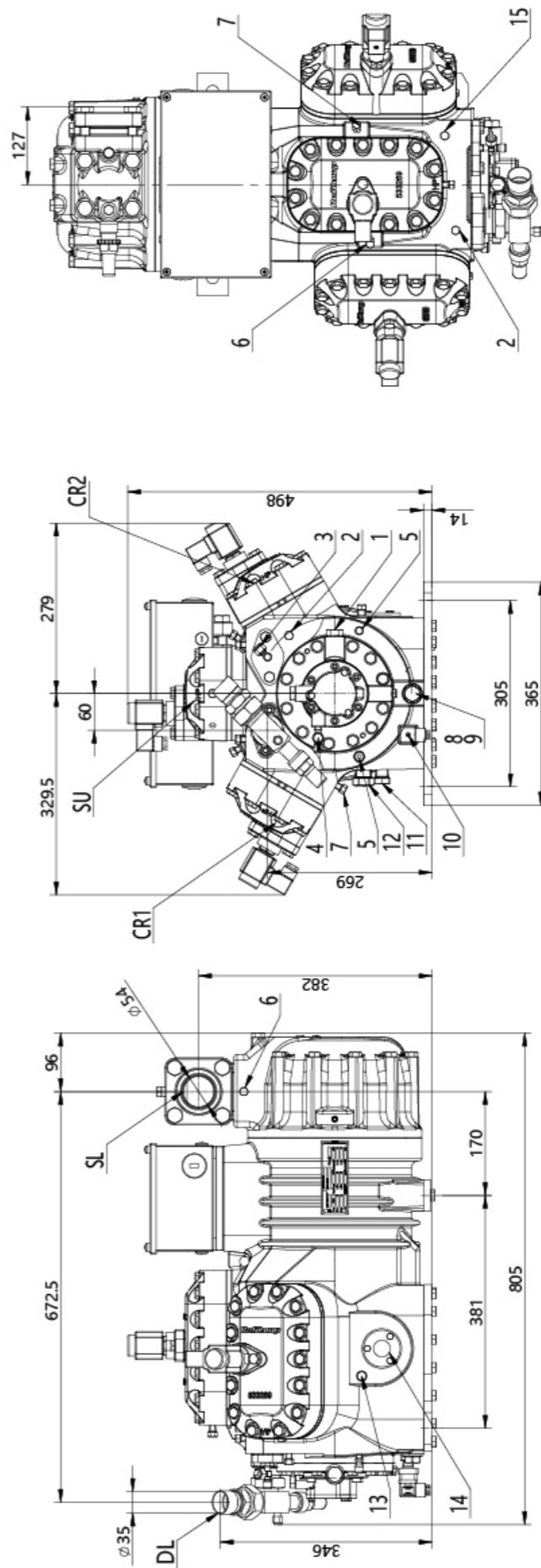

Key:

1	Electronic oil pressure switch connection
2	Discharge temperature sensor
3	High-pressure connection 1/4" SAE-FLARE
4	Oil high-pressure connection 1/4" SAE-FLARE
5	Oil low-pressure connection 1/4" SAE-FLARE
6	Low-pressure connection 1/8"NPT
7	Low-pressure connection 1/8"NPT (for liquid injection)
8	Oil filter
9	Oil drain plug
10	Crankcase heater
11	Connection for oil equalization (parallel operation)
12	Connection for gas equalization (parallel operation)
13	Oil chaming port 1/4" NPT

14	Oil sight glass
15	High-pressure connection 1/4" NPT
(DL)	Discharge shut-off valve
(SL)	Suction shut-off valve
(L1)	Solenoid valve level 1
(L2)	Solenoid valve level 2
(SU)	Start/unload solenoid valve

SP6L4000/SP6L400E,
SP6H5000/SP6H500E

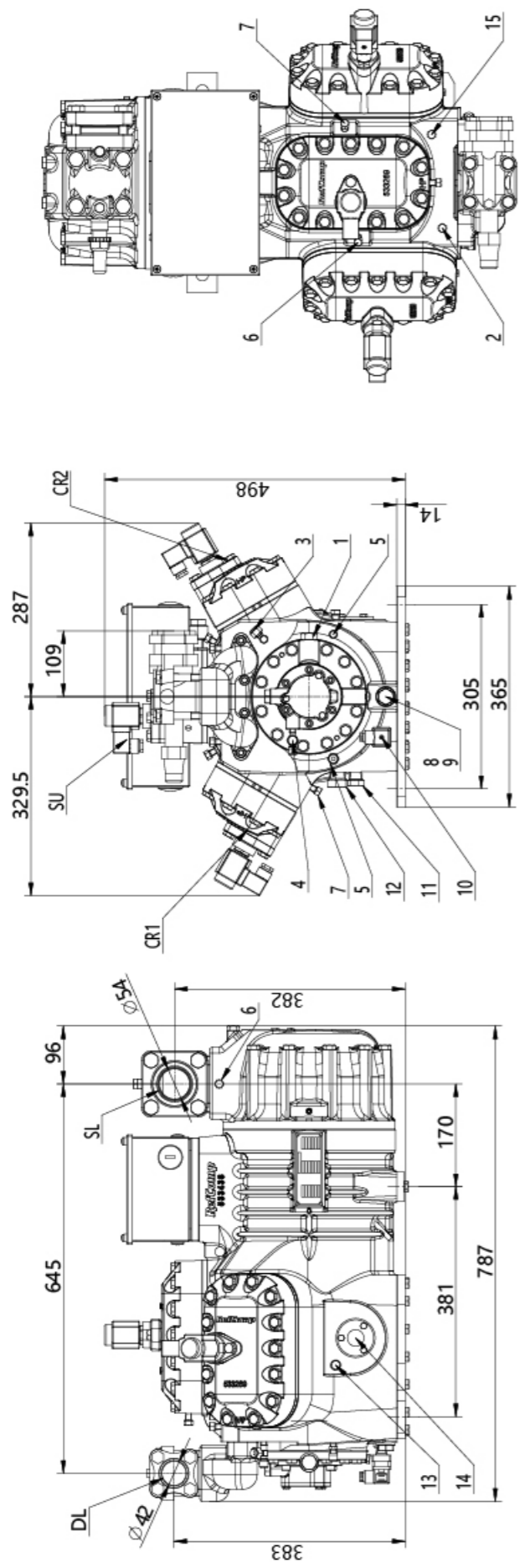

Key:

1	Electronic oil pressure switch connection
2	Discharge temperature sensor
3	High-pressure connection 1/4" SAE..FLARE
4	Oil high-pressure connection 1/4" SAE-FLARE
5	Oil low-pressure connection 1/4" SAE-FLARE
6	Low-pressure connection 1/8"NPT
7	Low-pressure connection 1/8"NPT (for liquid injection)
8	Oil filter
9	Oil drain plug
10	Crankcase heater
11	Connection for oil equalization (parallel operation)
12	Connection for gas equalization (parallel operation)
13	Oil charging port 1/4" NPT

14	Oil sight glass
15	High-pressure connection 1/4" NPT
(DL)	Discharge shut-off valve
(SL)	Suction shut-off valve
(L1)	Solenoid valve level 1
(L2)	Solenoid valve level 2

SP8H6000/SP8H600E, SP8H7000/SP8H700E;
SP8L5000/SP8L500E, SP8L6000/SP8L600E

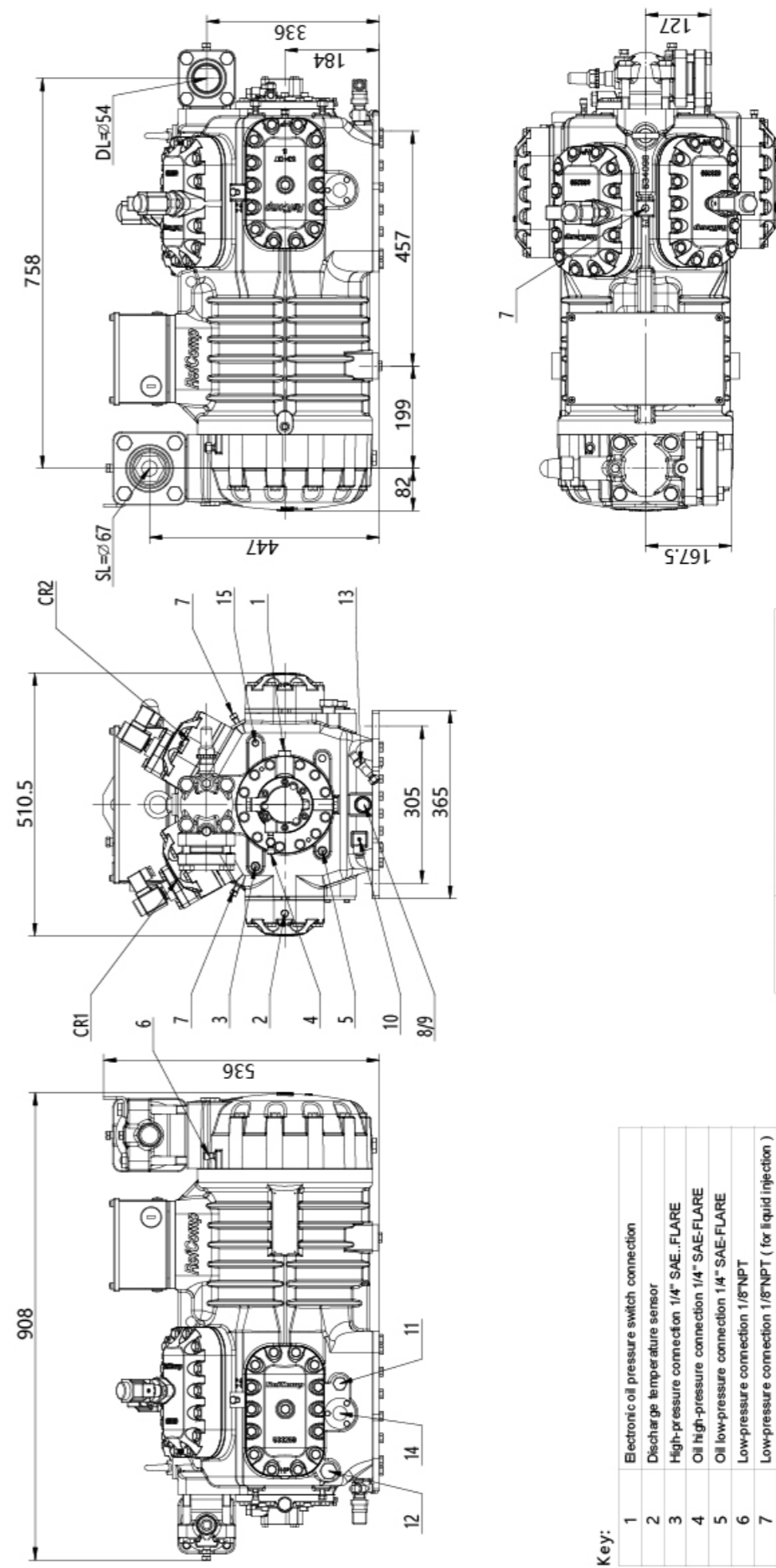

Key:

1	Electronic oil pressure switch connection
2	Discharge temperature sensor
3	High-pressure connection 1/4" SAE..FLARE
4	Oil high-pressure connection 1/4" SAE-FLARE
5	Oil low-pressure connection 1/4" SAE-FLARE
6	Low-pressure connection 1/8"NPT
7	Low-pressure connection 1/8"NPT (for liquid injection)
8	Oil filter
9	Oil drain plug
10	Crankcase heater
11	Connection for oil equalization (parallel operation)
12	Connection for gas equalization (parallel operation)
13	Oil charging port 1/4" SAE (as required)

14	Oil sight glass
15	High-pressure connection 1/4" NPT
(DL)	Discharge shut-off valve
(SL)	Suction shut-off valve
(L1)	Solenoid valve level 1
(L2)	Solenoid valve level 2